

382-404H HEAVY DUTY WHEELCHAIR w/ To-Fro Hangers (Port)

*** IMPORTANT ***

PLEASE RETAIN THIS INSTRUCTION SHEET IN YOUR FILES. IT CONTAINS IMPORTANT REPLACEMENT PARTS INFORMATION. ALL EQUIPMENT SHOULD BE INSTALLED IN ACCORDANCE WITH THESE INSTRUCTIONS.

IT IS IMPORTANT TO USE AND MAINTAIN ALL PUBLIC PLAYGROUND EQUIPMENT PROPERLY. PLAYGROUND EQUIPMENT WHICH IS IMPROPERLY MAINTAINED CAN CAUSE SERIOUS INJURY. PERIODICAL INSPECTIONS, MAINTENANCE, REPAIR AND/OR REPLACEMENT OF DAMAGED PARTS IS NECESSARY FOR SAFE OPERATION OF EQUIPMENT AND SAFETY OF USERS. RESILIENT SURFACING SHOULD BE USED UNDER ALL PLAYGROUND EQUIPMENT. APPROPRIATE PUBLICATIONS, AVAILABLE AT NO CHARGE, FROM THE CONSUMER PRODUCT SAFETY COMMISSION, INCLUDE "A HANDBOOK FOR PUBLIC PLAYGROUND SAFETY." YOU CAN RECEIVE YOUR FREE COPY BY CALLING 1-301-504-7908.

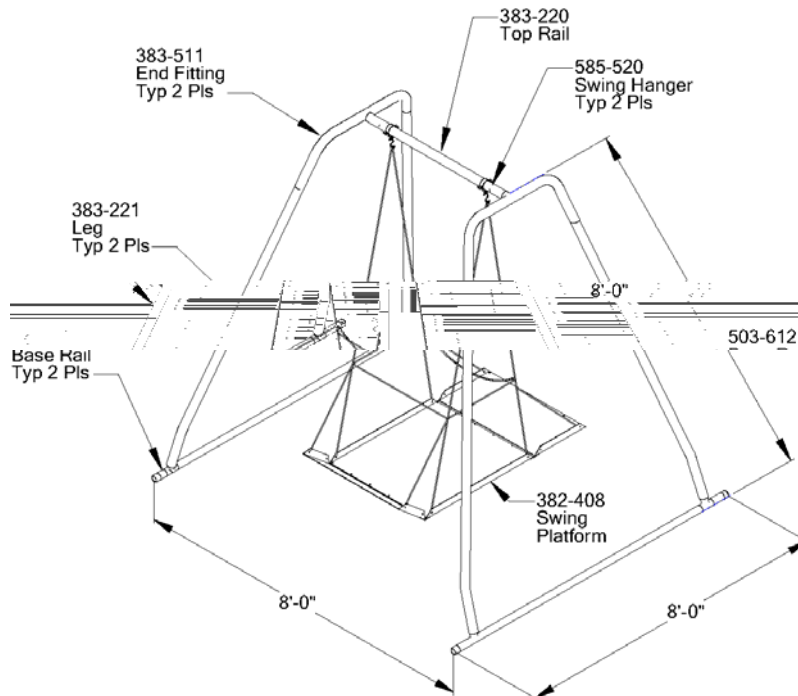

PACKING LIST

1	CTN	1	Hardware Bag
		1	383-414 Heavy Duty Main Platform/Chain Assembly
1	CTN	1	383-415 Heavy Duty Back Platform/Chain Assembly
		1	383-416 Heavy Duty Front Platform/Chain Assembly
2	WF	1	383-511 End Fitting
1	PIPE	1	383-220 Top Rail
4	PIPE	1	383-221 Leg
2	PIPE	1	503-612 Base Rail

HARDWARE BAG

4	PR	425-517	1 7/8" T-Clamp
4		535-960	Green Cap
4		535-961	Red Cap
2		582-504	2 3/8" Swing Hanger
4		116-540	5/16" x 2" Button Head Bolt
6		196-802	1/2" x 1/2" Socket Set Screw
4		326-501	5/16" Lock Washer
4		216-512	5/16" Button Head Nut
2		416-350	3/16" Socket Key
1		416-400	1/4" Socket Key
1		805-532	Warning Label
1		805-534	SportsPlay Label

2 CTN 2 WF 7 PIPE 11 TOTAL PCS WT 232# CLASS 70

GENERAL USE/FALL ZONE & FOOTING RECOMMENDATIONS

STATIONARY & PORTABLE EQUIPMENT - USE/FALL ZONES SHOULD EXTEND A MINIMUM OF 6 FEET IN ALL DIRECTIONS FROM THE PERIMETER OF THE EQUIPMENT GROUND SPACE. THIS AREA SHOULD BE COVERED WITH THE REQUIRED AMOUNT OF RESILIENT SAFETY SURFACING MATERIAL. FOR SOME EQUIPMENT - USE/FALL ZONES CAN OVERLAP. SEE CONSUMER PRODUCT SAFETY COMMISSION GUIDELINES. DIAMETER & DEPTH OF FOOTING ILLUSTRATED ARE SATISFACTORY IN MOST APPLICATIONS FOR PIPE SIZES UP TO 2 3/8" DIAMETER. VARYING SOIL & CLIMATIC CONDITIONS MAY REQUIRE DEEPER & HEAVIER FOOTINGS IN SOME AREAS. CHECK LOCAL BUILDING CODES.

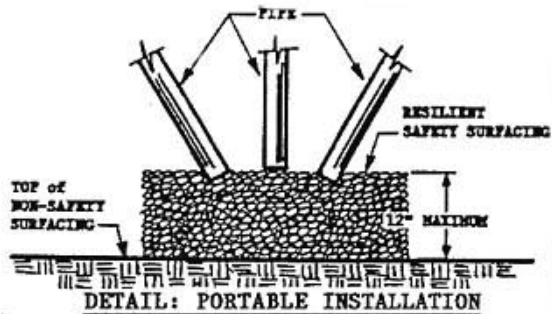

* If resilient surfacing is to be less than 12", then additional pipe should be put in concrete to maintain proper finish grade for equipment.



GENERAL USE/FALL ZONE & FOOTING RECOMMENDATION

SINGLE AXIS SWINGS:

The Use/Fall Zone should extend to the front & rear, a minimum distance of twice the height of the Top Rail above the resilient surfacing material. The Use/Fall Zone to the sides should follow the general recommendation of six feet minimum. This six foot zone may overlap that of an adjacent swing structure.

ROTATING SWINGS:

The Use/Fall Zone should extend in all directions the length of the swing plus six feet. The six foot minimum fall zone from the supporting structure also applies, and may overlap the six foot zone of an adjacent swing structure.

GENERAL MAINTENANCE INSTRUCTIONS:

Check MONTHLY for loose bolts, damaged or broken parts. Tighten and/or replace immediately. On swings and any equipment that uses S-Hooks and/or Swing Hangers check the bearing surfaces for wear. Replace any parts that show a reduction of 25% from the original size.

SPECIFIC ASSEMBLY INSTRUCTIONS:

NOTE: All threaded ends of bolts protruding beyond nuts must be cut off and/or peened to eliminate sharp edges. No more than two threads should extend beyond face of nut. All washers, "T" nuts, and other fastener hardware used on round pipe or tubing must be hammered down to conform to the curved underlying surface to eliminate catch points. DO NOT tighten nuts more than hand-tight until entire assembly is completed.

STEP #1: Assemble swing Frame on ground. Attach Top Rail & Legs to End Fittings.

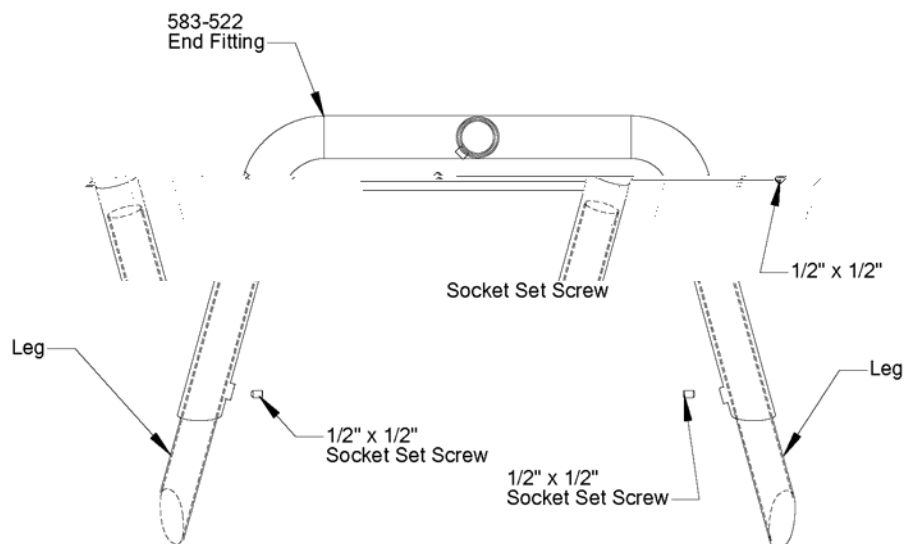

382-404H HEAVY DUTY WHEELCHAIR w/ To-Fro Hangers (Port)

Page 4

Rev 06/18/03

- STEP #2: Place Caps on ends of Base Rails. Placing Red Caps on first then Green Caps.
- STEP #3: Attach Frame Assembly to Base Rails with T-Clamps.
- STEP #4: Attach Swing hangers & Wheelchair Platform to Frame Assembly, then attach wheelchair platform to swing hangers with S-hooks. Close S-hooks.

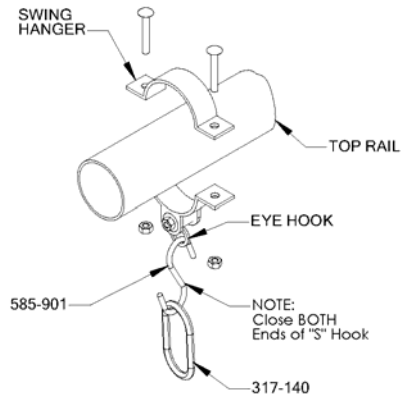

- STEP #5: Stand upright. Plumb & level entire unit. Tighten all nuts & bolts so that lock washers are flat. Use short length of pipe on end of socket key to add leverage when tightening socket set screws.
- STEP #6: Attach warning and manufacturer's Identification labels to a clean surface. The labels should be attached in a location where they are clearly visible and legible and away from normal hand and foot placement areas. The labels must be replaced if they become illegible, destroyed or removed. Contact your distributor for replacement labels.
- NOTE:** This event is intended for use ONLY under adult supervision. When not in use, be sure to secure platform to the frame to prevent misuse.