

**FREESTANDING 72" WAVE SLIDE
3-1/2" Vertical Posts**

USER GROUP: 2-12 years

RECOMMENDED CREW: 2 people

TOOLS REQUIRED:

T-30 TORX Tool (supplied by manufacturer)

T-45 TORX Tool (supplied by manufacturer)

3/16" Allen Head Wrench

Level

Shovel / Post Hole Digger / Auger

High Speed 3/8" Electric Drill *w/clutch*

NOTE: Use of any other driver on C-Line fittings may result in damage to tool and/or hardware!

CONCRETE REQUIRED: 19 cubic feet

NOTE: Concrete must have a minimum rating of 2,500 psi and must be mixed per manufacturer's recommendations.

WEIGHT: 700 lbs.

PRE-INSTALLATION CHECK:

Compare all items received to the packing list. Notify your local sales representative immediately if any parts are missing or damaged.

We are not responsible for items discovered missing after 72 hours from time of delivery!

Before beginning installation, make sure that you have read and understand the *Installation Introduction* manual that was supplied to you. If you did not receive a copy, or if you have a question regarding anything covered in this manual, contact your local sales representative.

**FREESTANDING 72" WAVE SLIDE
#90008036XX**

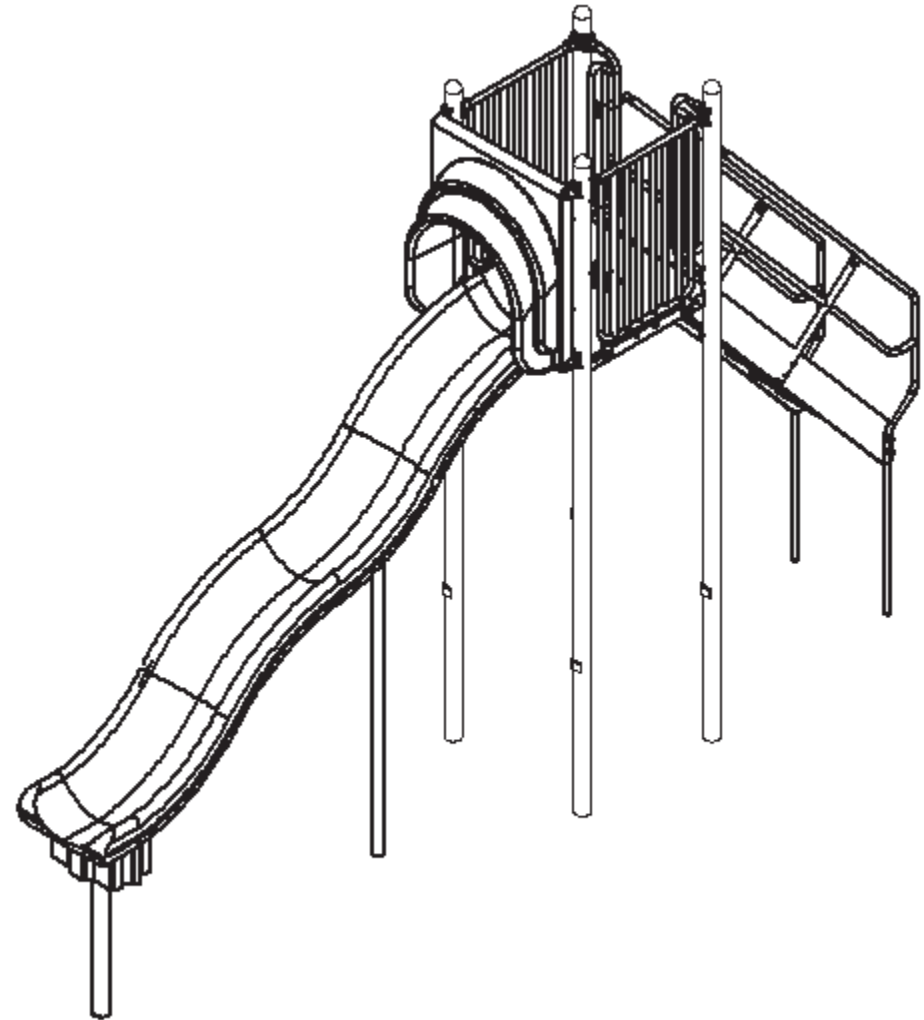

INSTALLATION GUIDELINES

STEP 1

Refer to PLAN VIEW and FOOTING DIAGRAM to locate position of slide.

STEP 2

Excavate footing as shown in FOOTING ELEVATION and FOOTING DETAIL. Place a 2" spacer block in bottom of each hole.

STEP 3

Select four 132" posts. Place in footing holes and brace in position.

STEP 4

Mark inside of vertical posts at 1-1/2" below platform height (EX: If platform height is 72", mark inside of posts at 70-1/2"). Drill a 21/64" hole into posts at marks.

STEP 5

Select four bolt hole gaskets. Place one gasket over each hole drilled in vertical posts. **NOTE:** The grommet will hold the gasket in place until the deck screws are installed.

STEP 6

Select platform, four 3/8"x1-1/2" self tapping TORX head screws, four bolt hole gaskets and four 3/8"x7/8" flat washers. Hold platform in position. Secure platform to vertical posts by inserting screw through washer, gasket, slot in platform and into pre-drilled hole in each post (see Detail A). **NOTE:** Screw will cut through the grommet and will leave a flat rubber washer in place around the screw. **NOTE:** Can install one or more self tapping TORX head screws and "hang" platform from these screws while the other side is being attached. **NOTE:** Must use high speed 3/8" electric drill w/ clutch. Use of any other driver may result in damage to tool and/or hardware!

STEP 7

Verify that platform is at correct elevation and that it is level. Select eight 1/4"x1" self drilling/tapping TORX head screws. Drive two self drilling/tapping screws into the bottom two holes at each corner of the platform (see Detail A). **NOTE:** Must use high speed 3/8" electric drill w/clutch. Use of any other driver may result in damage to tool and/or hardware!

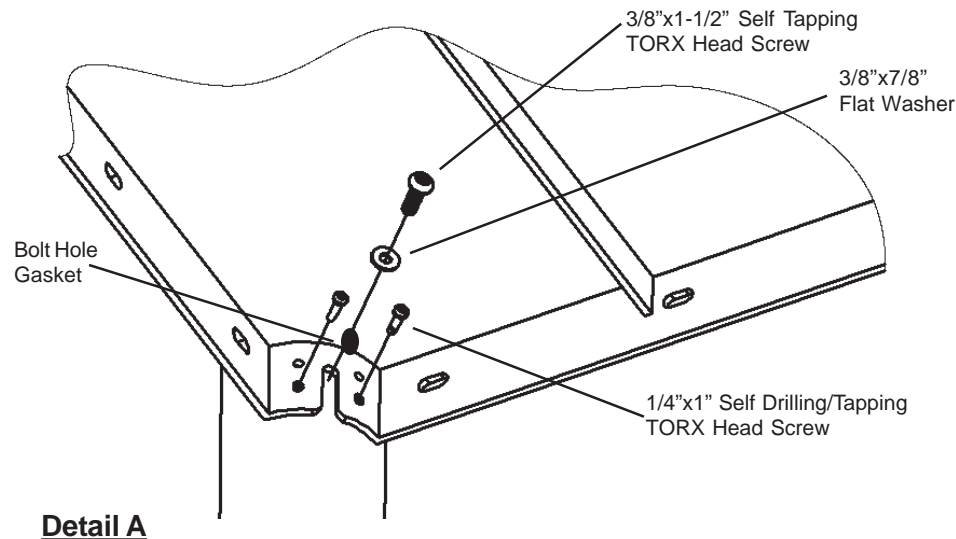

STEP 8

Select stair, four 3/8"x3/4" security TORX head bolts, four 3/8"x1-1/4" flat washers and four 3/8" round weld nuts. Set stair in place and block and brace into position. **NOTE:** Bottom of stair will be even with top of finished surfacing. From outside of stair, insert bolt through washer, stair, deck and into weld nut (see Detail B). Gently tighten until all connections are made then fully tighten hardware. Provide support for stair until installation is complete.

Detail B

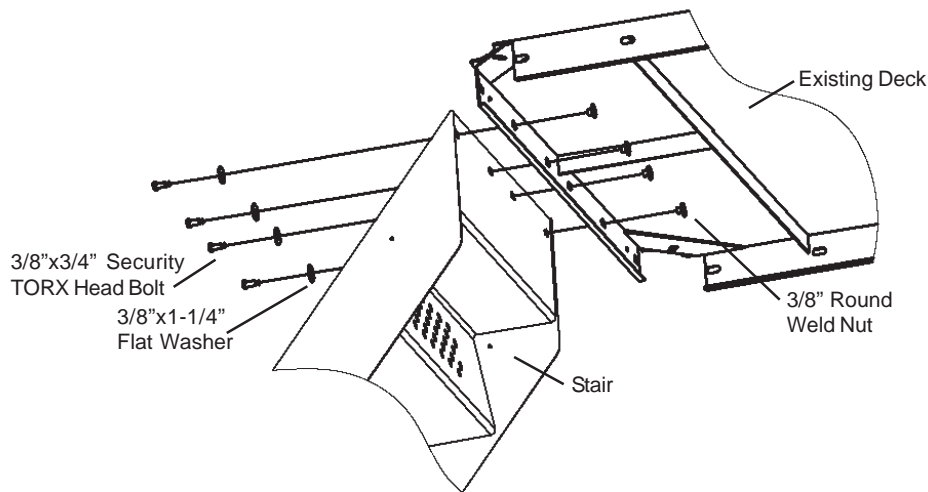

STEP 9

Select one handrail, two 3/8"x1-3/4" security TORX head bolts, two 3/8"x2-1/4" TORX head bolts and four 3/8"x1" round weld nuts. Attach handrail to stairs by inserting bolt through handrail, stair and into weld nut as shown in Detail B. Gently tighten until installation is complete. Repeat for other handrail. **NOTE:** Weld nut will be on inside of stairs (see Detail C).

Detail C

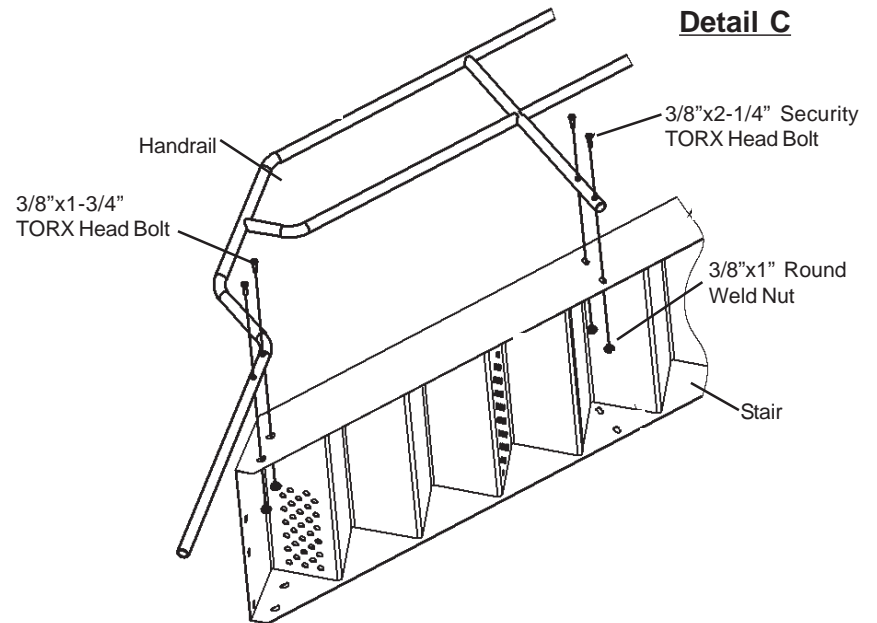

STEP 10

Select four C-Line pipe fittings and four adhesive gaskets. Remove backing from one side of adhesive gasket and press on to back side of fitting. **NOTE:** Gasket is covered with a strong adhesive -- do not press on fitting until gasket is centered. Repeat process for remaining gaskets and fittings (see Detail D).

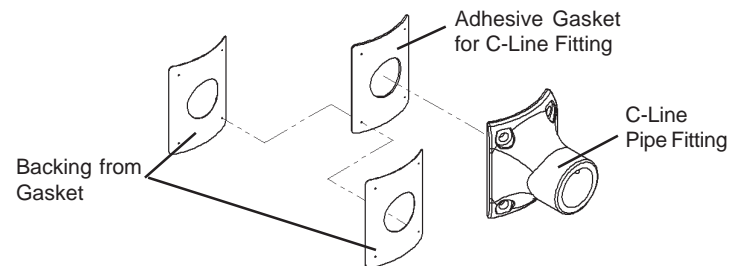

Detail D

INSTALLATION GUIDELINES

STEP 11

Select two C-Line pipe fittings with gaskets attached, two 3/8"x3/8" set screws and one stair gate. Position gate so that attachment plate is closer to top of gate. Remove backing from other side of fittings. Slide fittings over ends of stair gate. Hold gate in position making sure that it is oriented correctly, aligned with hand rails, level, plumb and at correct height. **NOTE:** Center of bottom fitting will be 2-1/2" above top of deck. When gate is positioned correctly, and handrails are lined up with holes in gates, press fittings on to vertical posts. **NOTE:** Gasket is covered with a strong adhesive -- do not press into place until stair gate is positioned correctly (see Detail E). Install and tighten one set screw per fitting.

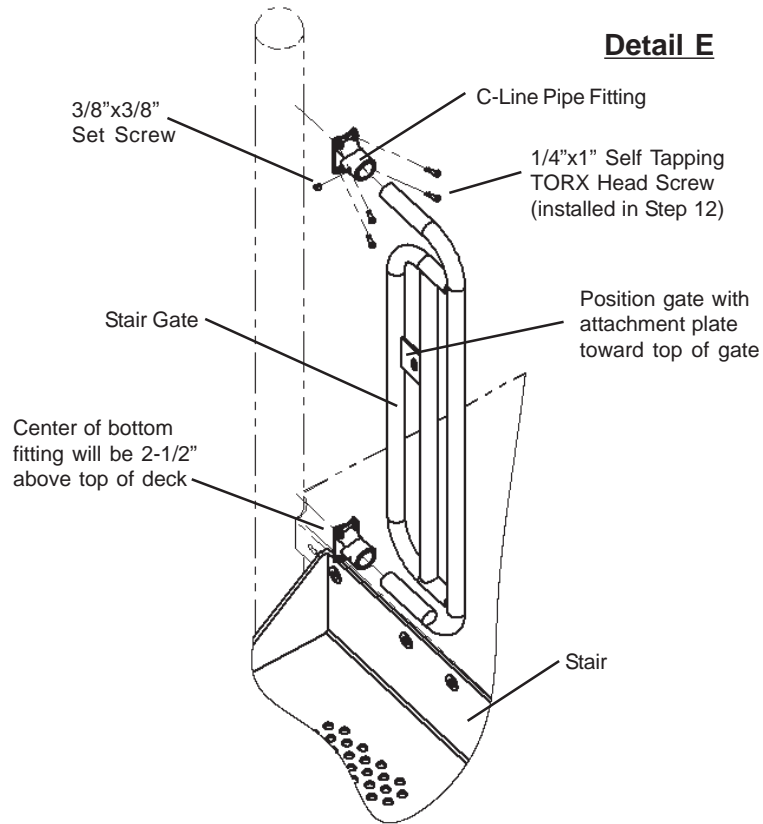

STEP 12

Select eight 1/4"x1" self tapping TORX screws. Secure each fitting to vertical post by installing four screws into each fitting. Lightly tighten until all four self tapping screws are installed. Then tighten all four self tapping screws. Repeat process for remaining fitting (see Detail E). **NOTE:** Must use high speed 3/8" electric drill w/clutch. Use of any other driver may result in damage to tool and/or hardware.

STEP 13

Repeat Steps 11-12 for remaining stair gate.

STEP 14

Select one 3/8"x1-1/4" TORX head bolt and one 3/8"x1-1/4" flat washer. Attach handrail to gate by inserting bolt through washer, gate and screwing into handrail (see Detail F). Repeat for other handrail. Gently tighten until installation is complete. Then tighten all.

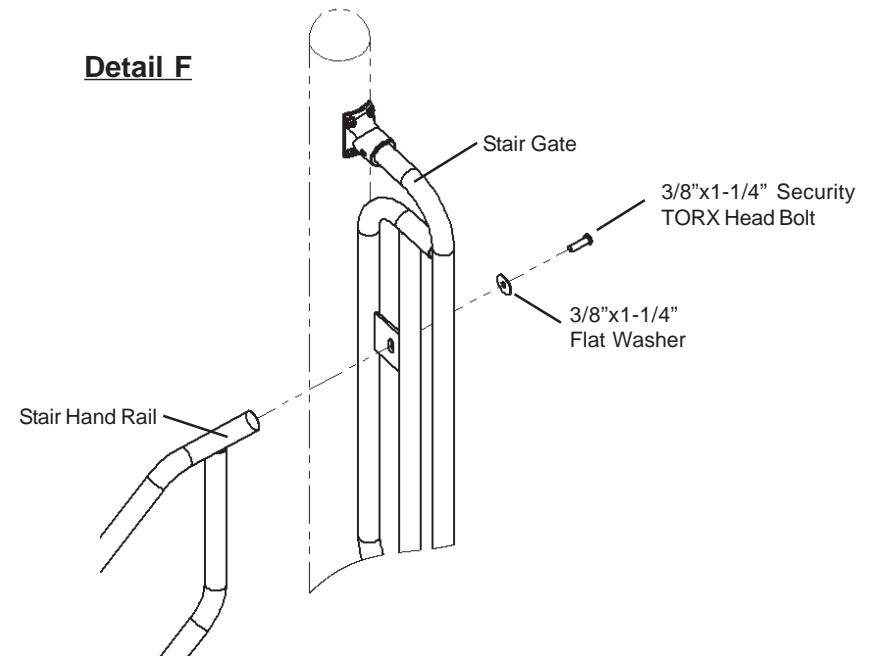

INSTALLATION GUIDELINES

STEP 15

Select pipe wall, two 3/8"x1" security TORX head bolts, four 3/8"x1-1/4" flat washers and two 3/8" standard nuts. Set pipe wall in place and align holes in pipe wall with holes in deck. From outside of deck, insert bolt through washer, pipe wall, deck, washer and into nut (see Detail G). Repeat process for other side of pipe wall. Do not tighten hardware at this time.

Detail G

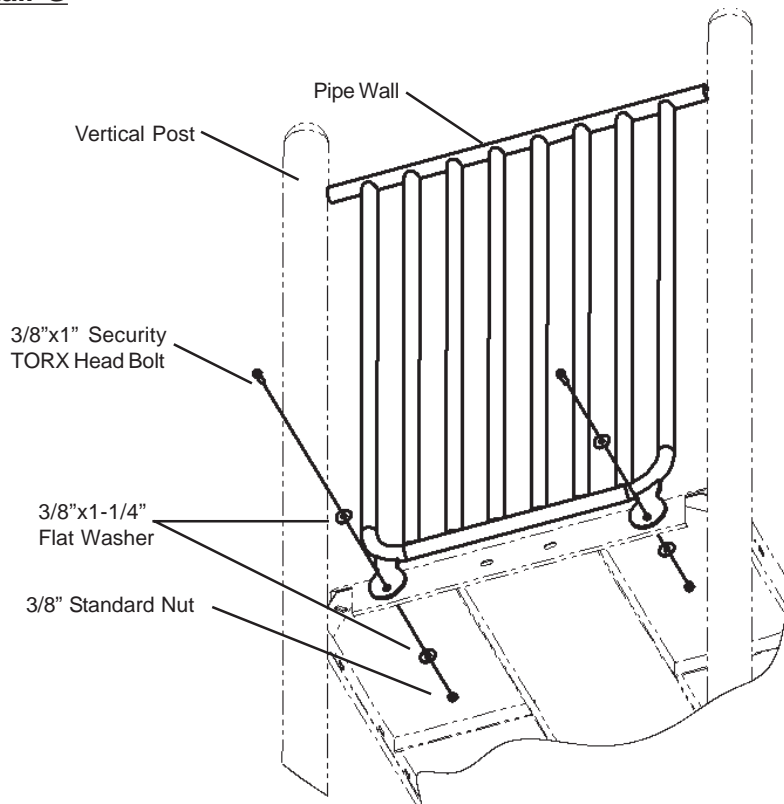

STEP 16

Select two adhesive gaskets and two C-Line pipe fittings. Remove backing from one side of gasket and press on to back side of fitting (See Detail H). **NOTE:** Gasket is covered with a strong adhesive - do not press on fitting until gasket is centered.

Detail H

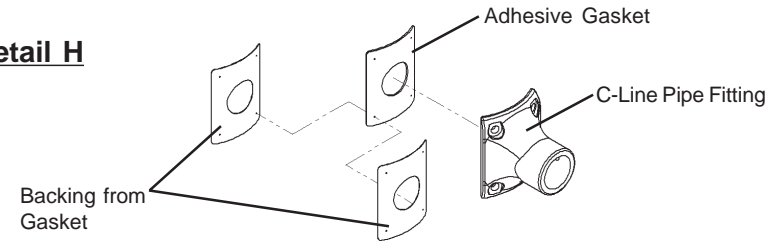

STEP 17

Select two C-Line pipe fittings and two 3/8"x3/8" set screws. Remove backing from other side of gaskets. Tilt top of pipe wall away from posts. Slide fittings over ends of pipe wall as far as possible (See Detail I). Tilt pipe wall toward posts. Center pipe wall in grid and assure that it is level and plumb. Slide each fitting toward vertical post and press into place. **NOTE:** Gasket is covered with a strong adhesive -- do not press fitting into place until pipe wall is in correct location. Install and tighten set screws.

Detail I

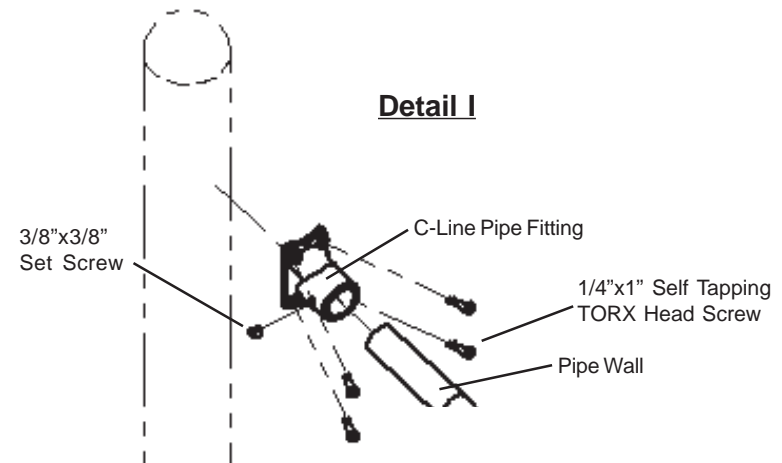

STEP 18

Select eight 1/4"x1" self tapping screws. Secure fittings to vertical posts using four screws per fitting (see Detail I).

STEP 19

Repeat Steps 15, 16, 17 and 18 for other side.

STEP 20

Select slide, standard slide foot, four 3/8"x1" security TORX head bolts and four 3/8" flat washers. Attach slide foot to slide by inserting bolt through washer, slide foot and into slide (see Detail J).

NOTE: Slide will be pre-drilled with threaded inserts installed.

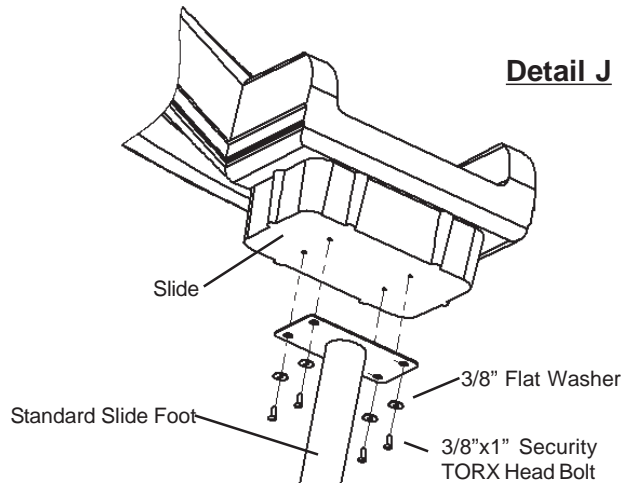

STEP 21

Select slide mid support, four 3/8"x1" security TORX head bolts and four 3/8" flat washers. Attach support to slide by inserting bolt through washer, slide foot and into slide (see Detail K).

NOTE: Slide will be pre-drilled with threaded inserts installed.

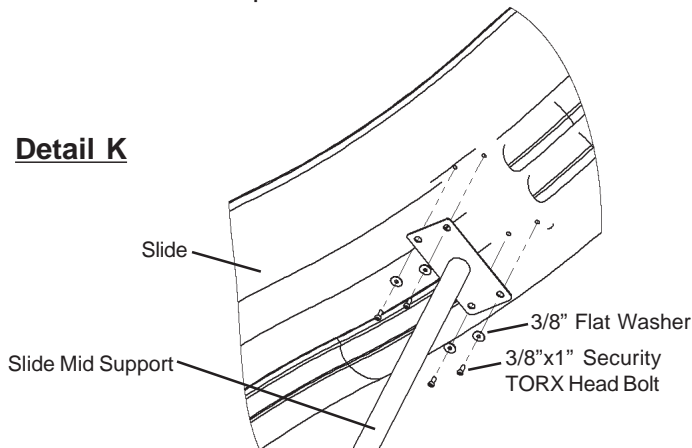

STEP 22

Select slide and four 1/4"x1-3/4" wafer bolts. Set slide in place. Block and brace to correct height. Attach slide to deck by inserting wafer bolt through deck and into slide (see Detail L). **NOTE:** Slide will be pre-drilled with threaded inserts installed.

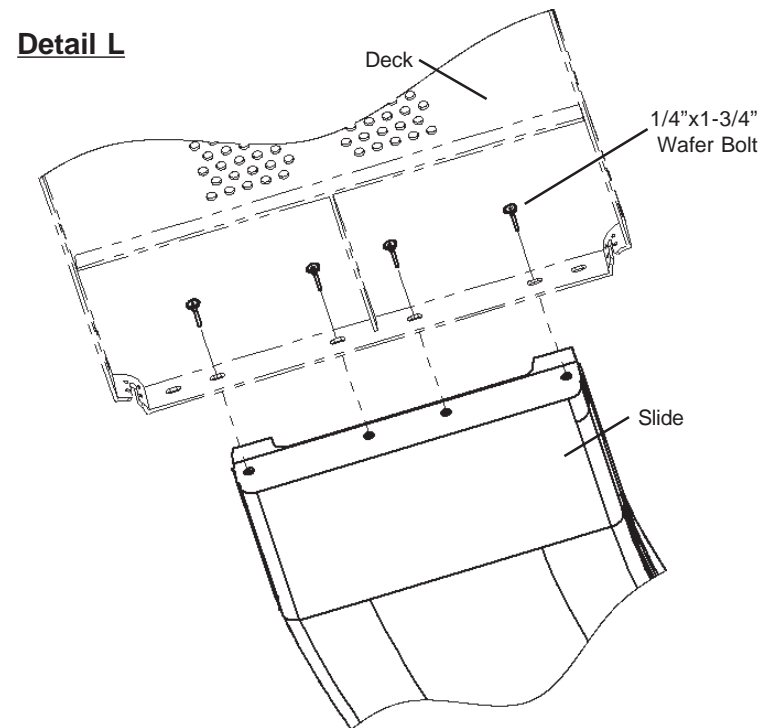

INSTALLATION GUIDELINES

STEP 23

Select four adhesive gaskets for C-Line fitting and four 3-1/2" C-Line hood attachment fittings. Remove backing from one side of gasket and press on to back side of fitting. **NOTE:** Gasket is covered with a strong adhesive -- do not press on fitting until gasket is centered. Repeat process for remaining gaskets and fittings (see Detail M).

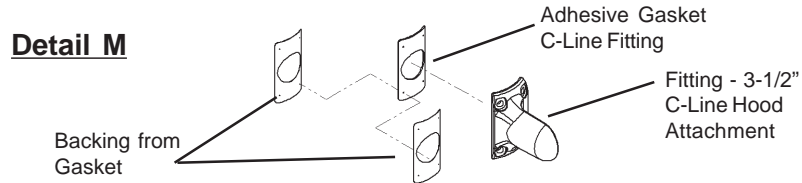

STEP 24

Select slide hood, four C-Line fittings with gaskets attached and four 1/4"x1-1/2" button head bolts. Attach fittings to each corner of slide hood as shown in Detail N. Remove backing from other side of gaskets.

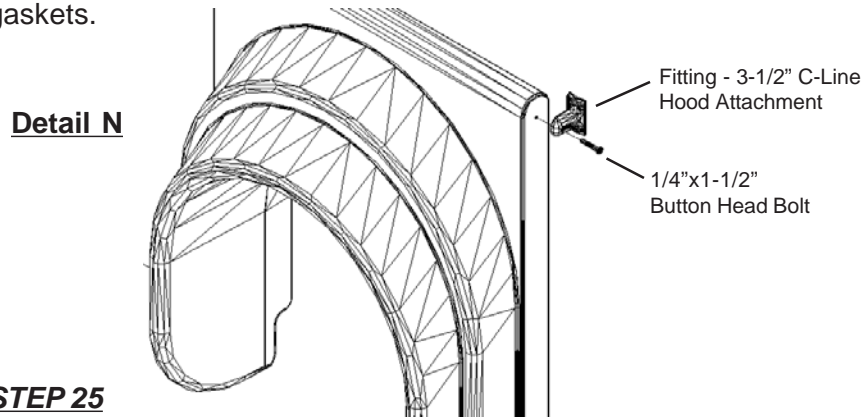

STEP 25

Select eight 1/4"x1" self tapping screws. Set slide hood in place. **NOTE:** Gasket is covered with a strong adhesive -- do not press on pipe until hood is centered, level and at correct height (bottom of slide hood will be even with top of deck). Install two self tapping screws in each fitting - only two holes of each fitting are accessible at this time (see Detail O). Gently tighten until both screws are installed. Then tighten all. **NOTE:** Must use high speed 3/8" electric drill *w/clutch*. Use of any other driver may result in damage to tool and/or hardware.

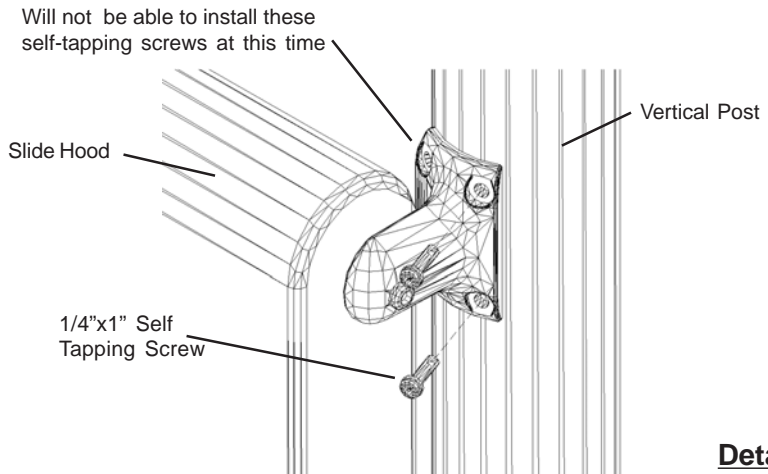

STEP 26

Detach hood from fittings. Install remaining two self tapping screws in each fitting. Gently tighten until both screws are installed. Then tighten all (see Detail P). **NOTE:** Must use high speed 3/8" electric drill *w/clutch*. Use of any other driver may result in damage to tool and/or hardware.

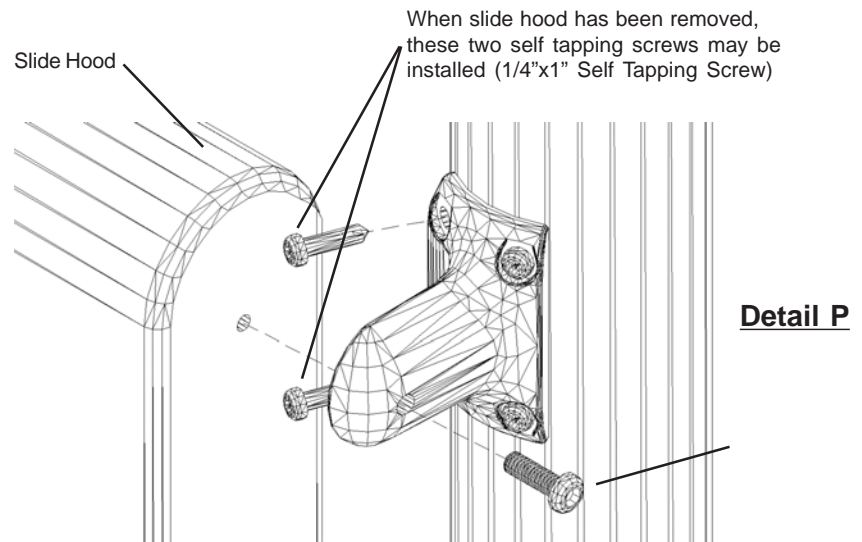

STEP 27

Reattach hood to fittings on all four corners as shown in Detail Q.

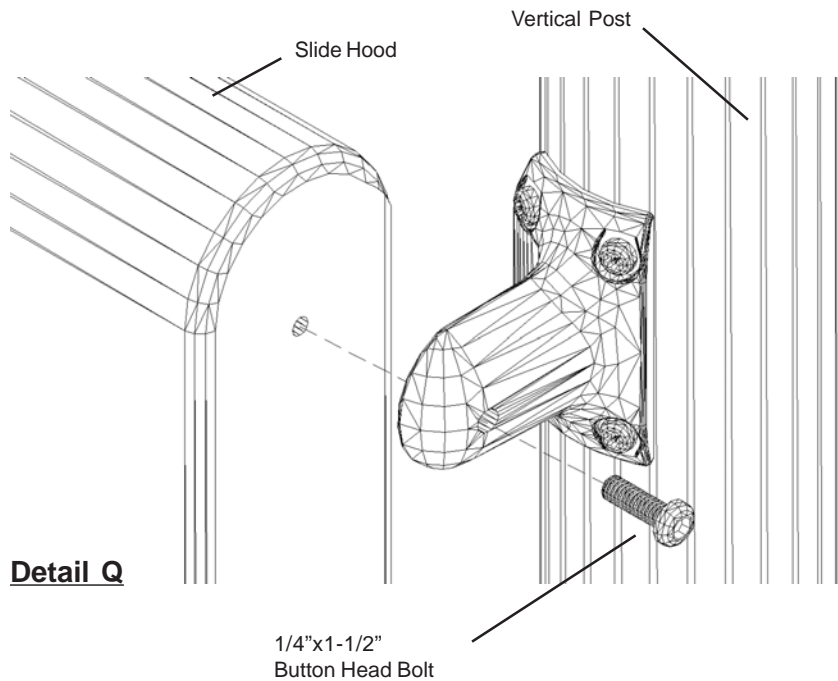

Detail Q

STEP 28

Ensure all hardware is secure and that components are level and plumb.

STEP 29

Pour concrete in footings to correct level. **Allow concrete to harden for at least 48 hours before use!** **NOTE:** Concrete must have a minimum rating of 2,500 psi and must be mixed per manufacturer's recommendations.

BILL OF MATERIALS

ITEM NO.	QTY.	PART NO.	DESCRIPTION
1	1	PFM21859XX	Stair - 72" Standard
2	2	HRA01766XX	Handrail - 72" Stairs
3	4	2080011792	Bolt - 3/8"x1-3/4" Security Torx w/Patch
4	30	2090010292	Washer - 3/8"x1-1/4" Flat
5	4	812056T	Bolt - 3/8"x2-1/4" Torx w/Patch
6	12	2100040292	Nut - 3/8" Standard
7	4	812052T	Bolt - 3/8"x3/4" Torx w/Patch
8	4	2100010392	Nut - 3/8"x1" Round Weld Nut
9	2	2080011492	Bolt - 3/8"x1-1/4" Security Torx w/Patch
10	8	CTG10004XX	Fitness Pipe Mount Fitting 3-1/2"
11	10	HDW32550XX	3-1/2" Sealing Gasket
12	48	2080000192	Screw - 1/4"x1" Self Tapping Torx w/Patch
13	8	2080040192	Set Screw - 3/8"x3/8" Allen Head
14	2	AFB40779XX	Fab Wdmt. - Stair Gate 3-1/2" C-Line
15	1	07420XX	Slide - Wave 72" Plastic
16	4	2080060192	Bolt - 1/4"x1-3/4" Wafer
17	1	07666XX	C-Line Hood 36"
18	12	2080011192	Bolt - 3/8"x1" Security Torx w/Patch
19	1	30008501XX	Fab Wdmt. - Standard Slide Foot
20	2	AFB40846XX	Fab Wdmt. - Pipe Wall 3-1/2" C-Line
21	4	116501	Screw - 3/8"x1-1/2" Tapping Security Torx
22	4	2090010492	Washer - 3/8"x7/8" OD Flat
23	2	CTA10006XX	Fitting - Hood Mount 3-1/2" C-Line
24	1	30008511XX	Support Foot For 72" Wave Slide
25	2	CTG10006XX	Fitting - Hood Mount 3-1/2"
26	2	20800112XX	Bolt - 1/4"x1-1/2" Button Head

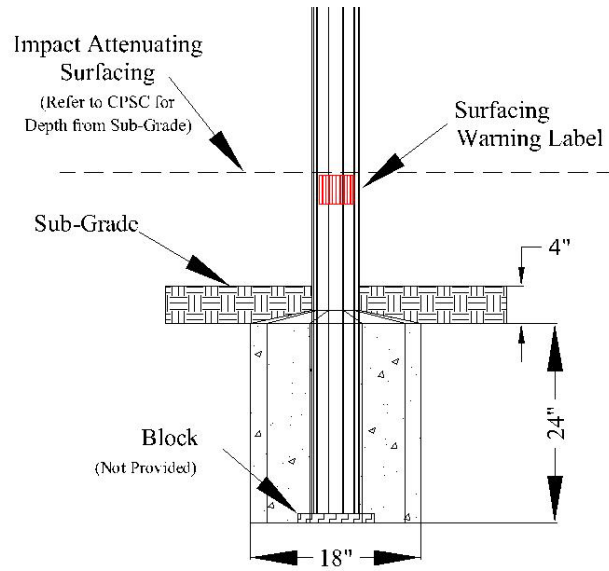

FOOTING ELEVATION - VERTICAL POST

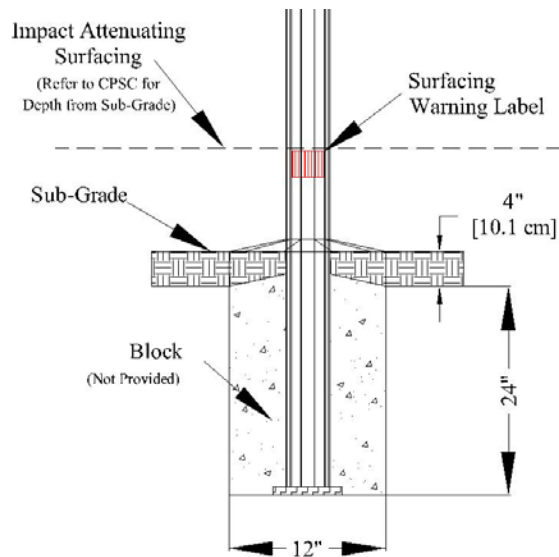

FOOTING ELEVATION - STAIR AND SLIDE FOOT

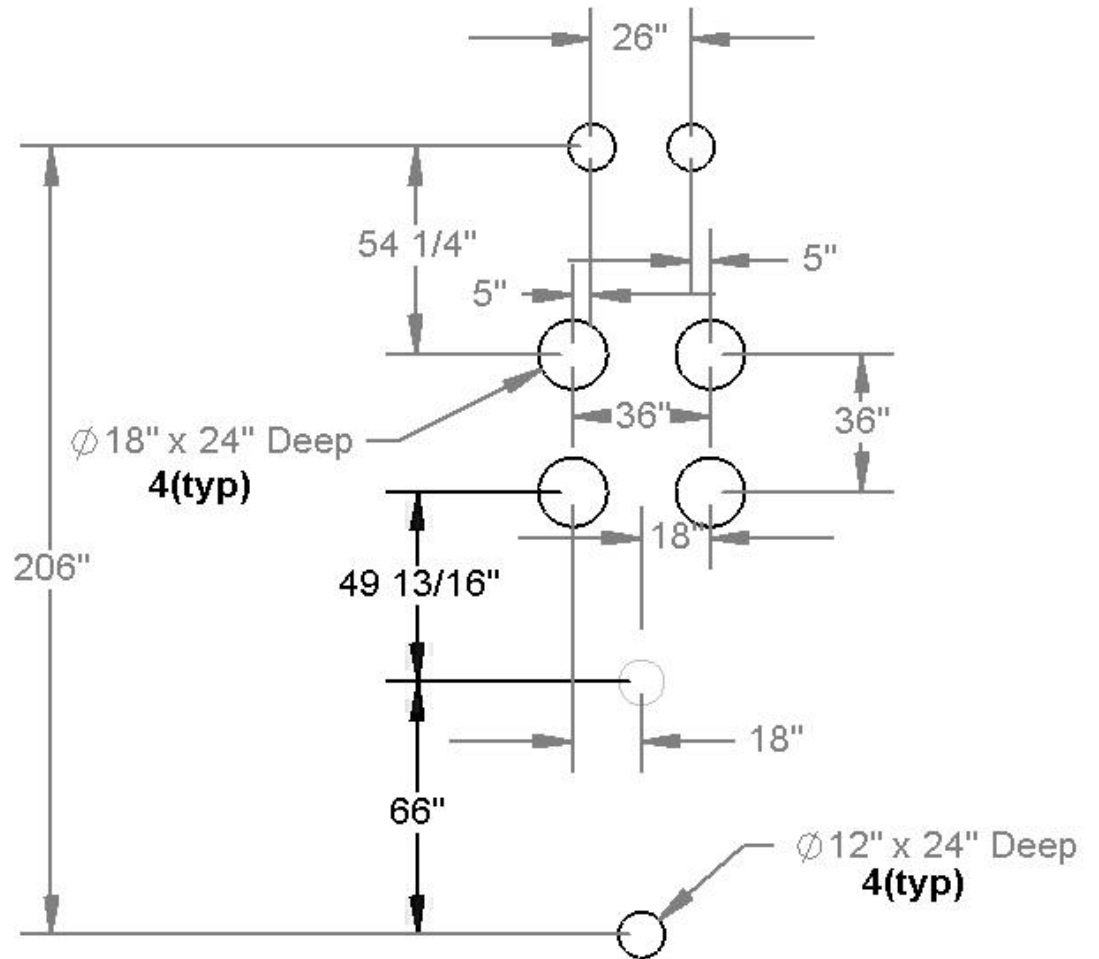

Footing Diagram

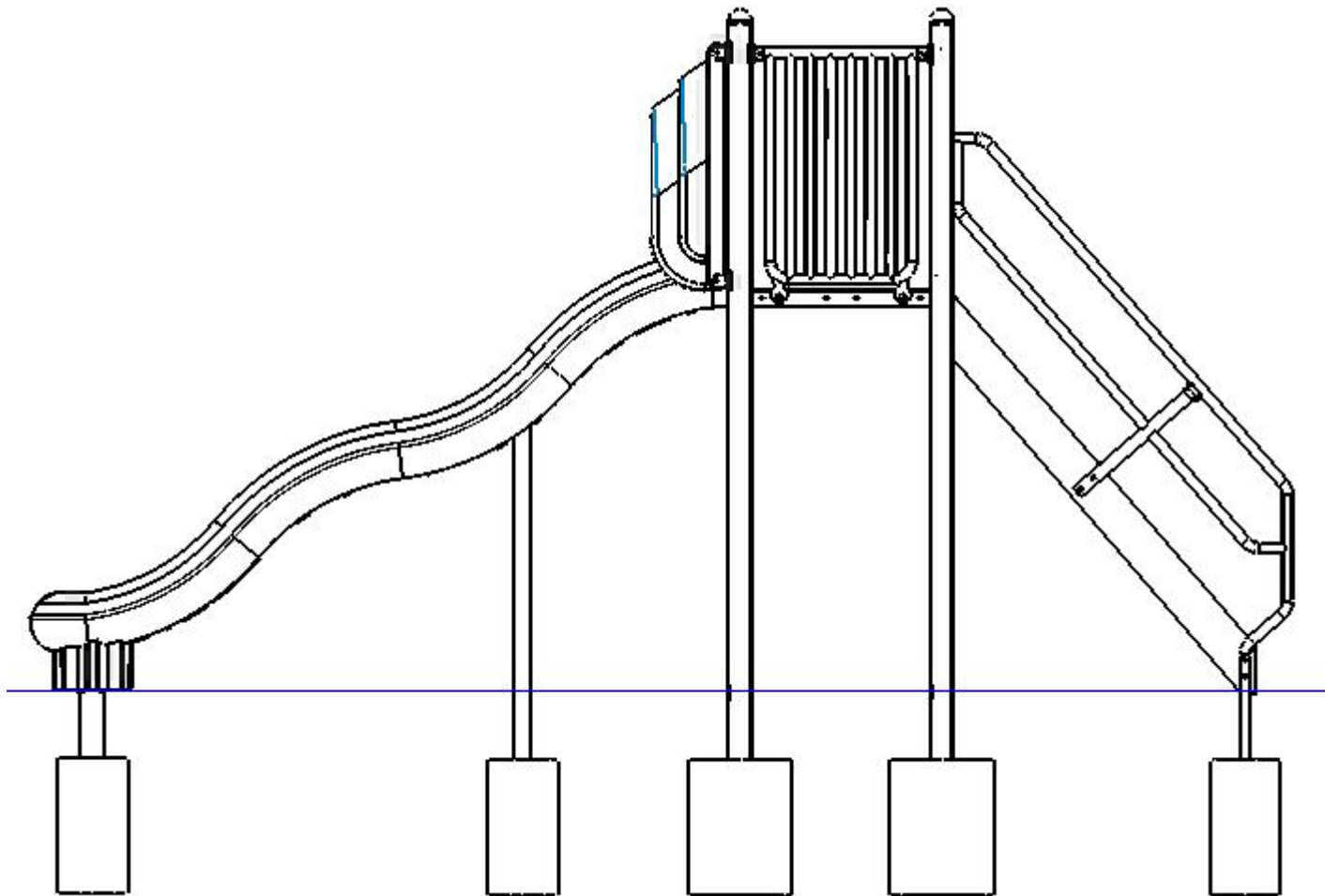

SIDE ELEVATION

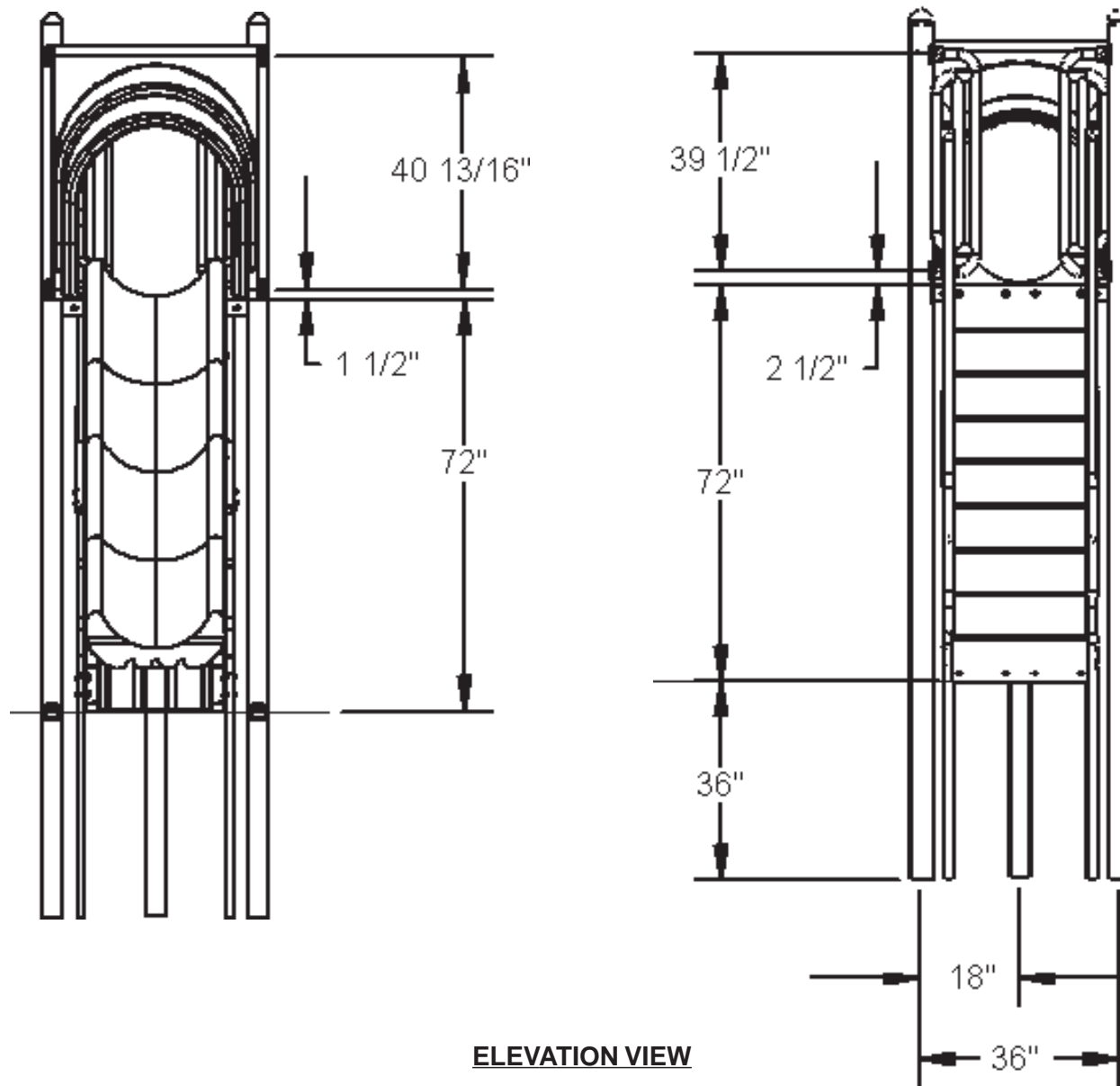

ELEVATION VIEW

PRODUCT SPECIFICATIONS**PLATFORM**

- 12 gauge steel -- hot rolled, pickled and oiled flat
- 50,000 psi yield strength (ASTM E-8)
- 55,000 psi tensile strength (ASTM E-8)
- Perforated surface
- Plastisol coating

STAIRS

- Sides - 12 gauge HR steel
- Treads - 12 gauge HRPO steel
- Bead - 0.25" dia HR steel
- Plastisol coating

STAIR GATE & STAIR RAILS

- 1-1/4" O.D. round steel tube
- 14 gauge steel
- 50,000 psi yield strength (ASTM E-8)
- 55,000 psi tensile strength (ASTM E-8)
- Triple zinc coated undercoat
- Powder coat finish

PIPE WALL

- 1-1/4" O.D. round steel tube
- 14 gauge steel
- 50,000 psi yield strength (ASTM E-8)
- 55,000 psi tensile strength (ASTM E-8)
- Triple zinc coated undercoat
- Powder coat finish

FITTINGS

- Aluminum alloy (GM70B) manufactured and tested in accordance with the following ASTM Standards: B179-68, B108-68, E10-66, E8-66
- Powder coat finish
- Predrilled

ADHESIVE GASKET

- Neoprene rubber
- 60 +/- 5 durometer hardness
- Double sided adhesive

PLASTISOL COATING

- MISTAFLEX V4612
- 80-100 mills thick
- Shore A, 65-70 durometer min. hardness (ASTM D2240-66T)
- 1,000 psi minimum tensile strength (ASTM D638, D412)
- Resistant to abrasion (ASTM D4060)
- UV stabilized
- Self-extinguishing
- Textured finish shows less dirt
- Increased traction

PRODUCT SPECIFICATIONS

SLIDE / HOOD

- 1st quality linear low density Polyethylene (ExxonMobil LL8450)
- Rotational molded
- 2,550 psi tensile strength (ASTM D638)
- UV stabilized
- Anti-static inhibitors

SLIDE FOOT

- 3.5" O.D. support post
- 13 gauge galvanized steel support post
- 45,000 psi yield strength (ASTM E-8)
- 48,000 psi tensile strength (ASTM E-8)
- 12 gauge galvanized steel plate
- Triple Flo-Coated corrosion protection (interior/exterior)
- Interior and exterior corrosion resistance (ASTM B-117)
- Manufactured per ASTM 500
- Powder coat finish

HARDWARE

- Conforms to ANSI/ASCE-8-90
- Tamper resistant
- Special tool required for install

PRETREATMENT WASH PRIMER

- 4860-420 primer / 1000-44 activator
- Polyvinyl-butylal resin based primer
- Used on all milled steel and all weld joints
- Designed to give adhesion to a wide variety of metal substrates
- Provides added metal protection against rust
- Imparts extra durability to topcoat (powder coat)
- When reduced properly, it meets the definition of a "pretreatment" primer found in many air quality regulations

POWDER COAT FINISH

- TGIC polyester
- Electrostatic application
- Baked-on @ 400 degrees
- 5-7 mills thick
- Lead free
- High gloss
- No peel / No flake finish
- Resistant to salt spray (ASTM B117)
- Resistant to humidity (ASTM D2247)
- Direct/Indirect impact 120 in. pounds (ASTM D2794)
- Good to excellent resistance to most solvents, oils, acids and alkalis