

### 1-Seat Firetruck Spring Rider 80603051XX

**Installation Time:** 1-1/2 hours  
**Concrete Required:** 3-1/2 cubic feet

#### **REQUIRED TOOLS:**

Shovel  
Wheelbarrow  
Concrete Trowel  
Short Level  
Rubber Mallet  
T-30 TORX Tool (supplied by manufacturer)  
Post Hole Digger / Auger  
Heavy cardboard for 18" diameter concrete form

#### **PRE-INSTALLATION CHECK**

Compare all items received to the packing list. Notify your local sales representative immediately of any missing or damaged parts.

**We are not responsible for items discovered missing after 72 hours from time of delivery!**

Before beginning installation, make sure you have read and understand the Installation Introduction manual that was supplied to you. If you did not receive a copy, or if you have a question regarding anything covered in this manual, contact your local sales representative.

#### **USE ZONE**

The use zone for rocking/springing equipment upon which the user is intended to sit shall be no less than 72" (1830 mm) in all directions from the at-rest perimeter of the equipment. The use zones of adjacent rocking/springing equipment intended for sitting may overlap when each structure consists of a seat or designated play surface with a height of 30" (760 mm) or less above the protective use zone surfacing when unoccupied. Use zone overlaps vary when structures other than riders are adjacent.

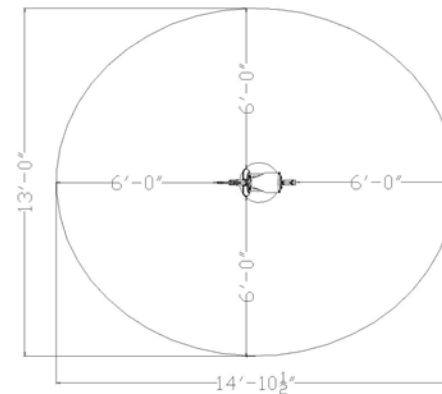

## INSTALLATION GUIDELINES

### **STEP 1:**

Select four 12" long concrete anchors, eight 1/2" washers and four 1/2" nuts. Turn the spring assembly over on its side. Insert the threaded ends of the four anchors up through the bottom four holes in the spring assembly base plate (See Anchor Detail).

### **STEP 2:**

Place one washer over each anchor end. Thread one nut onto each anchor until the threads just start to exit nut. Anchor bolts will dangle from base plate when the spring assembly is positioned above concrete form.

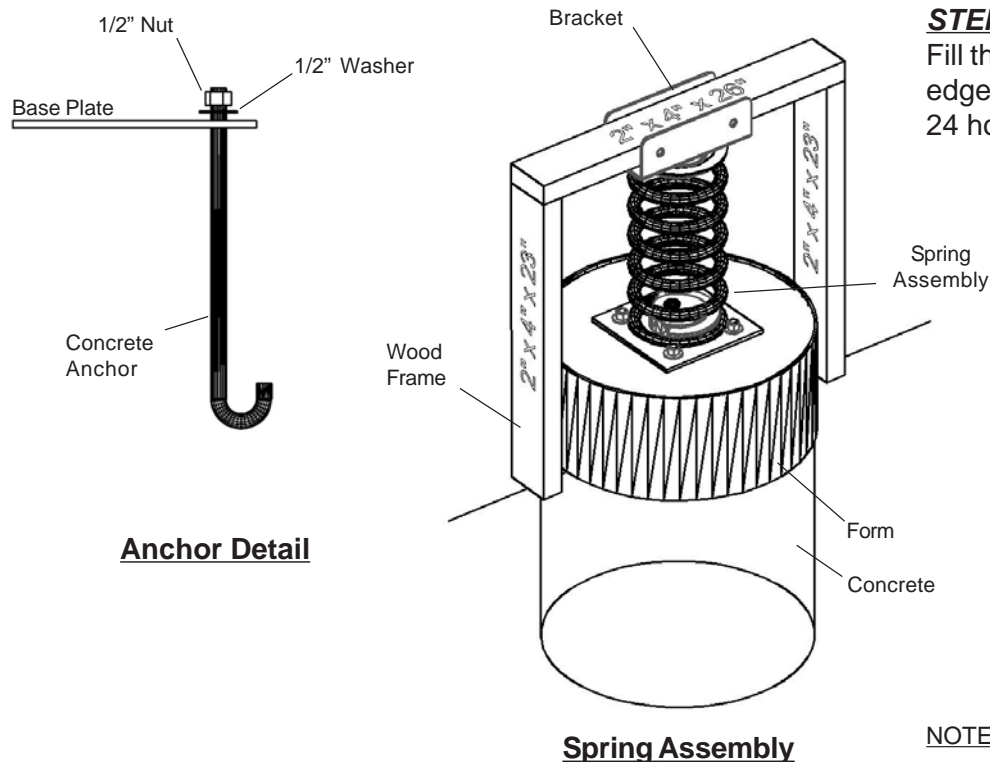

### **STEP 3:**

Excavate footing hole as shown in Footing Elevation below. Use heavy cardboard, or tube to form the portion of concrete cylinder above hard grade. Top of form should stand 8" above grade.

### **STEP 4:**

Block and brace spring assembly over the top center of the form. A frame constructed from scrap wood works well (see Spring Assembly Detail). The rider bracket should be oriented with open ends in direction that rider will face. Base plate bottom should be level with top edge of form. Level entire spring assembly.

### **STEP 5:**

Fill the hole and form with concrete until it touches base plate. Bevel top edge of concrete to eliminate sharp corner. Allow concrete to harden for 24 hours before continuing assembly.

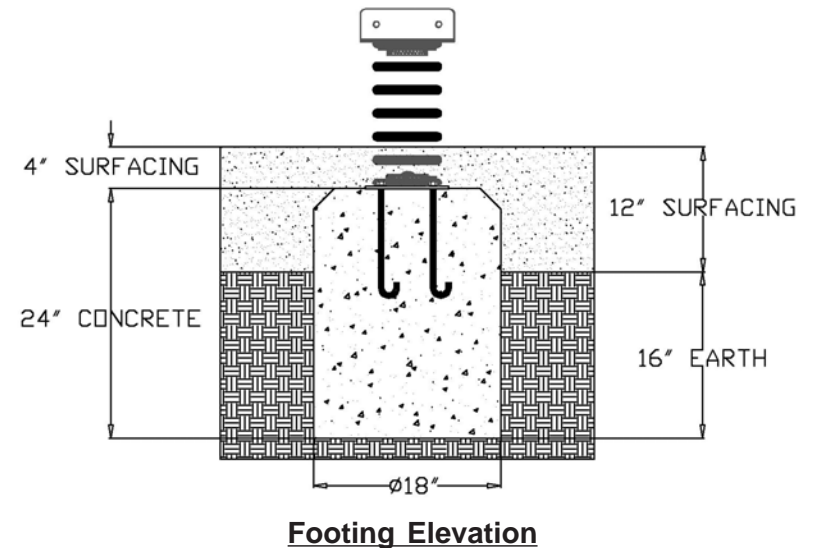

**NOTE:** Footing Elevation shown with 12" of surfacing and 8" of concrete above grade. The height of your concrete above grade will vary depending on your surfacing depth. You must maintain 4" of surfacing above base plate.

## INSTALLATION GUIDELINES

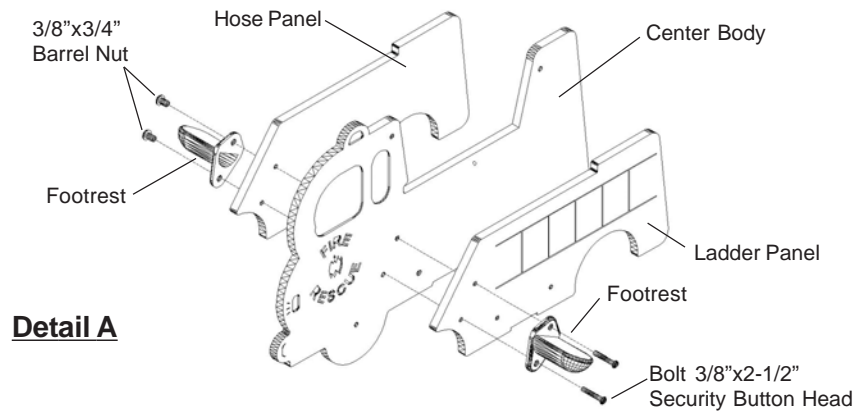

**Detail A**

### **STEP 6:**

Select center body, hose panel, ladder panel, two footrests, two 3/8"x3/4" barrel nuts and two 3/8"x2-1/2" security button head bolts. Tap barrel nuts through holes in footrest. Align barrel nut ends with the holes in outer body (hose panel). **NOTE:** Flat portion of footrest should face toward seat. Insert bolts through other footrest, ladder panel, center body, hose panel and into footrest. Tighten hardware. (See Detail A).

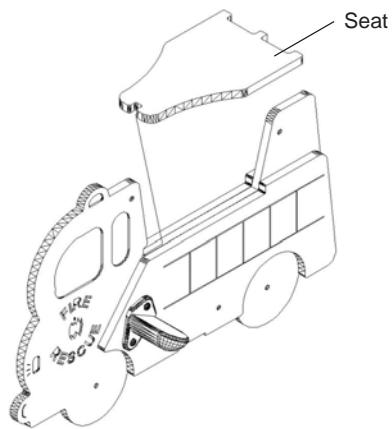

**Detail B**

### **STEP 7:**

Select seat. From the top, slide the notch at the front of the seat down into the notch in the center body. Press down on rear of the seat until it rests on body assembly. The rib at the tail of seat may need to be tapped into position with the rubber mallet (See Detail B).

**Detail C**

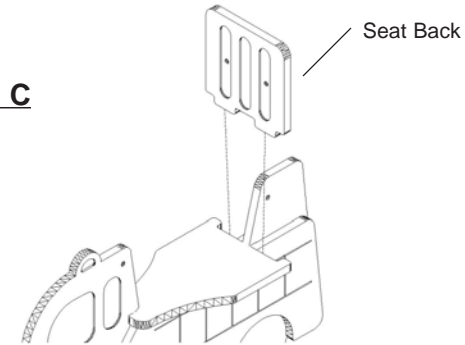

### **STEP 8:**

Select seat back. With graphic cuts forward, slide seat back with ribs downward into the openings at the back of seat. Tap into position with rubber mallet (See Detail C).

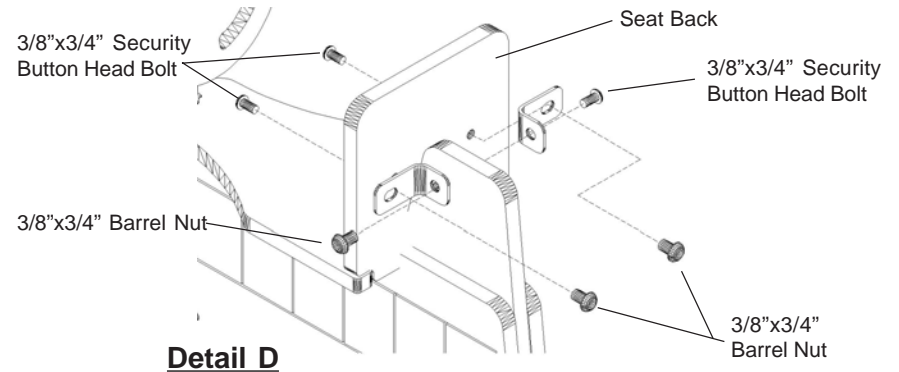

**Detail D**

### **STEP 9:**

Select one 90 degree bracket, one 3/8" x 3/4" barrel nut, and one 3/8"x3/4" security button head bolt. Align slot on the long leg of the 90 degree bracket with hole in the seat back. From the back, place barrel nut through bracket slot and into hole in seat back. Insert security bolt into seat from the front. Gently tighten hardware. Repeat process for bracket on opposite side of center column (See Detail D).

## **STEP 10**

Select one 3/8" x 3/4" barrel nut and one 3/8"x3/4" security button head bolt. Pivot both brackets so that holes on short legs are aligned with the hole in center column. Insert barrel nut through the closest bracket and into center column. Insert security bolt through opposite bracket (See Detail D). Fully tighten all hardware.

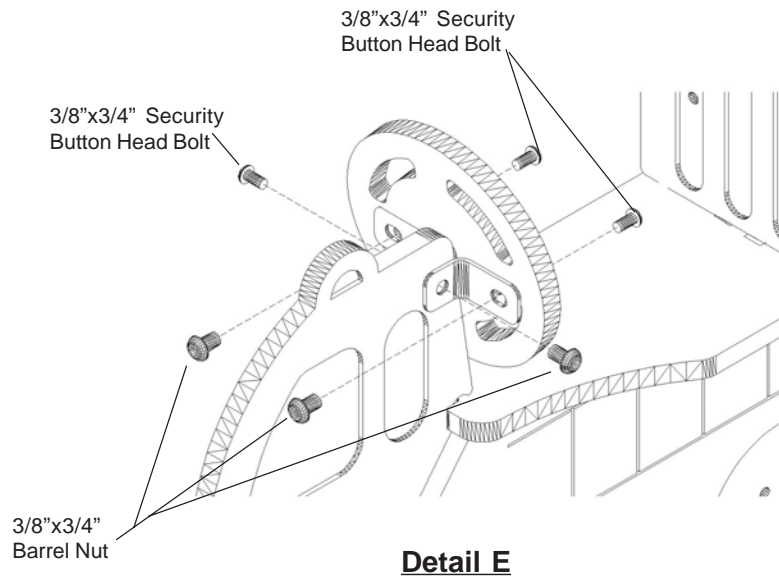

## **STEP 11**

Select steering wheel, one 90 degree bracket, one 3/8" x 3/4" barrel nut, and one 3/8"x3/4" security button head bolt. Align slot on long leg of bracket with one of the holes on back (non graphic) side of the steering wheel. Insert barrel nut through the bracket slot and into wheel hole. Insert security bolt through front side of steering wheel. Gently tighten hardware. Repeat procedure for bracket on opposite side of center body (See Detail E).

## **STEP 12**

Select one 3/8" x 3/4" barrel nut and one 3/8"x3/4" security button head bolt. Pivot 90 degree brackets so that holes on short legs are aligned. Slide the steering wheel assembly down over the center body until holes in brackets align with those in body. Insert barrel nut through bracket and into center body. Insert security bolt into opposite bracket. Fully tighten all hardware (See Detail E).

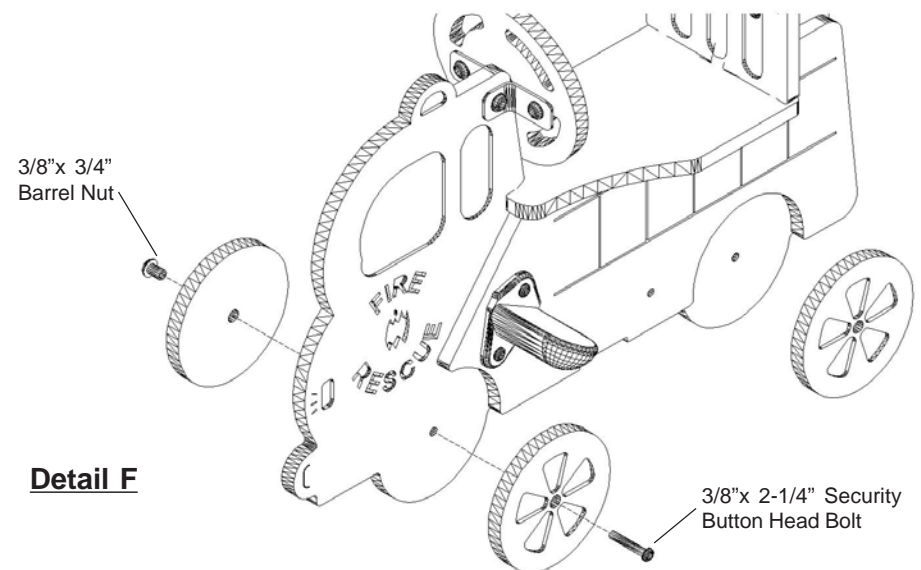

## **STEP 13:**

Select two wheels, one 3/8"x2-1/4" security button head bolt and one 3/8"x3/4" barrel nut. From outside of wheel (graphic cuts side) tap barrel nut into wheel. From outside of other wheel (graphic cuts side) insert bolt through wheel, main body, other wheel and into barrel nut. Tighten hardware. Repeat process for rear wheels (See Detail F).

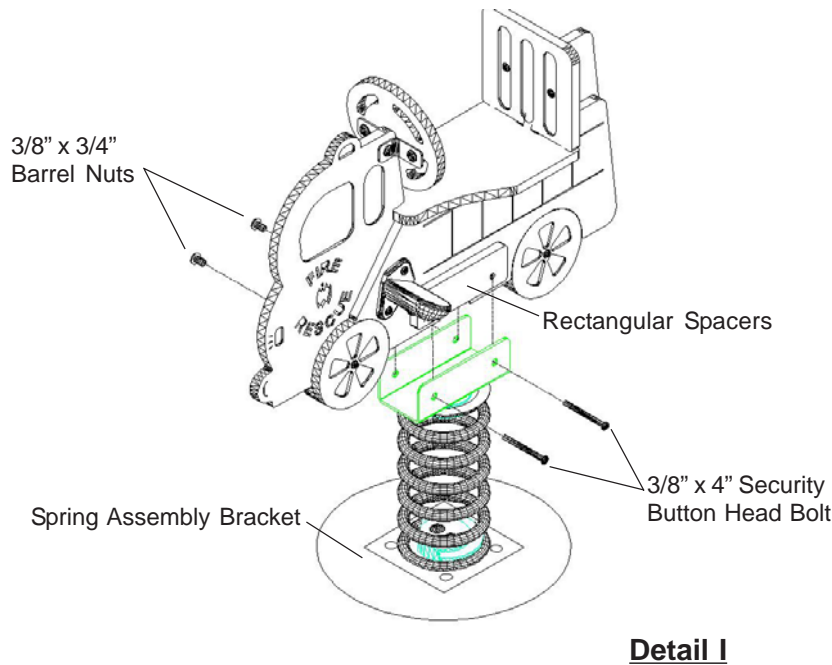

## BILL OF MATERIALS PART / HARDWARE LIST

| <u>Part Description</u>          | <u>Part No.</u> | <u>Qty.</u> |
|----------------------------------|-----------------|-------------|
| 1) Firetruck 1-Seat Center Body  | 10418012XX      | 1           |
| 2) Firetruck 1-Seat Hose Panel   | 10418010XX      | 1           |
| 3) Firetruck 1-Seat Ladder Panel | 10418011XX      | 1           |
| 4) Seat Back                     | 10418004XX      | 1           |
| 5) Rectangular Spacer            | 10418005XX      | 2           |
| 6) Seat                          | 10418007XX      | 1           |
| 7) Steering Wheel-Round          | 10418013XX      | 1           |
| 8) 90 Degree Bracket             | 10318103        | 4           |
| 9) Wheel (Tire)                  | 10418014XX      | 4           |
| 10) Coil Spring                  | 10018001        | 1           |
| 11) Base Plate                   | 10318008        | 1           |
| 12) Spring Casting               | 10218102        | 2           |
| 13) Rider Bracket                | 10318104        | 1           |
| 14) Footrest                     | 10218101        | 2           |
| 15) *Rider Hardware Bag w/Tools  | N/A             | 1           |

### **STEP 15:**

Select two rectangular plastic spacers, two 3/8"x3/4" barrel nuts and two 3/8"x4" security button head bolts. Place one spacer along each inside wall of spring assembly bracket. Align holes in spacers with those in bracket sides. One person should lift the rider body and insert it into the bracket between the spacers. Align holes in rider body with holes in bracket and spacers. A second individual then inserts two barrel nuts through one side of bracket holes and into spacer. This individual then inserts two security bolts through holes in opposite bracket side. Fully tighten all hardware (See Detail I). **NOTE:** Allow concrete to harden for at least 48 hours (total) before use.

\*NOTE: All hardware supplied in bag may not be required for this assembly.

## PRODUCT SPECIFICATIONS

### **RIDER**

- 3/4" high density Polyethylene sheeting
- Tested in accordance with ASTM D1928 Procedure C
- Textured finish
- 4,400 psi tensile strength (ASTM D638)
- UV stabilized
- 9 color options

### **SPRING ASSEMBLY**

- 5160 H steel alloy
- Carbon Chromium grade of spring steel
- 5-3/4" O.D. spring
- 13/16" O.D. bar
- Black powdercoat finish

### **HARDWARE**

- Type 304 (18-8) stainless steel
- Conforms to ANSI/ASCE-8-90
- 84 ksi tensile strength
- 42 ksi yield strength
- Tamper resistant
- Special tool required for install

### **PRETREATMENT WASH PRIMER**

- 4860-420 primer / 1000-44 activator
- Polyvinyl-butylal resin based primer
- Used on all milled steel and all weld joints
- Designed to give adhesion to a wide variety of metal substrates
- Provides added metal protection against rust
- Imparts extra durability to topcoat (powder coat)
- When reduced properly, it meets the definition of a "pretreatment" primer found in many air quality regulations

### **POWDER COAT FINISH**

- TGIC Polyester
- Electrostatic application
- Baked-on @ 400 degrees
- 5-7 mills thick
- Lead free
- High gloss
- No peel / No flake finish
- Resistant to salt spray (ASTM B117)
- Resistant to humidity (ASTM D2247)
- Direct/Indirect impact 120 in. pounds (ASTM D2794)
- Good to excellent resistance to most solvents, oils, acids and alkalis
- 13 color options