

**ALPINE THUNDER SLIDE
#TAD02057XX**

USER GROUP: 2-12 years

RECOMMENDED CREW: 2 people

TOOLS REQUIRED:

T-30 TORX Tool (supplied by manufacturer)

T-45 TORX Tool (supplied by manufacturer)

Shovel / Post Hole Digger / Auger

1/4" Allen Head Wrench

Level

High Speed 3/8" Electric Drill w/clutch

NOTE: Use of any other driver may result in damage to tool and/or hardware!

CONCRETE REQUIRED: 10.5 cubic feet

NOTE: Concrete must have a minimum rating of 2,500 psi and be mixed per manufacturer's recommendations.

INSTALLATION TIME: Approximately 3 hours

WEIGHT: 421 lbs.

**ALPINE THUNDER SLIDE
#TAD02057XX
3-1/2" Vertical Posts**

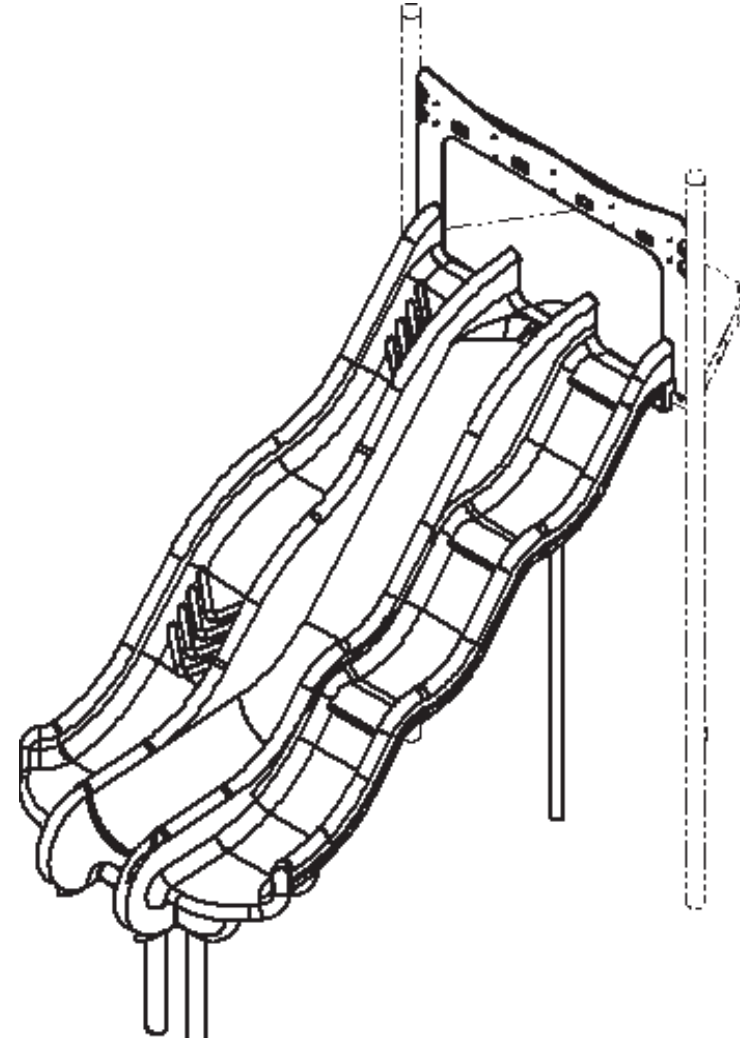

PRE-INSTALLATION CHECK:

Compare all items received to the packing list. Notify your local sales representative immediately if any parts are missing or damaged.

We are not responsible for items discovered missing after 72 hours from time of delivery!

Before beginning installation, make sure that you have read and understand the **Installation Introduction** manual that was supplied to you. If you did not receive a copy, or if you have a question regarding anything covered in this manual, contact your local sales representative.

INSTALLATION GUIDELINES

STEP 1

Refer to PLAN VIEW and FOOTING LAYOUT to locate position of Alpine Thunder Slide.

STEP 2

Excavate footing holes as shown in FOOTING LAYOUT and FOOTING ELEVATION. Place a 2" spacer block in the bottom of each hole. Provide temporary support under long side of deck until installation is complete.

STEP 3

Select two standard slide feet, alpine thunder slide, eight 3/8"x1-1/4" flat washers and eight 3/8"x1" TORX head bolts. Align slide foot with inserts in bottom of slide. Secure slide foot to slide by inserting bolt through washer, slide foot and into inserts in slide (see Detail A).

NOTE: Each slide foot uses four sets of hardware.

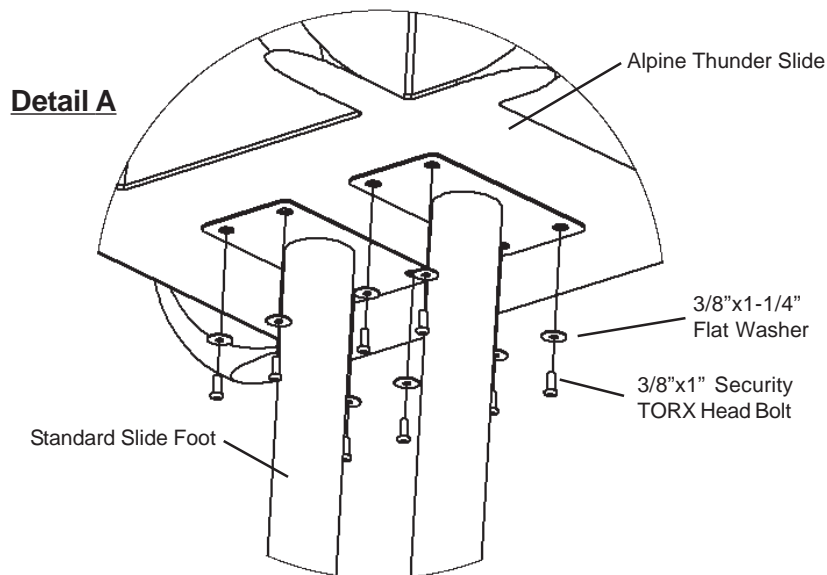

STEP 4

Select half hex deck support post, alpine cover plate one 3/8"x1-1/4" flat washer and one 3/8"x1-1/2" TORX head bolt. Place support post in footing hole with threaded end facing up. Place cover plate on top of deck. Align flat side of cover plate with edge of deck. Attach cover plate to post by inserting bolt through washer, plate and into threaded end of post (see Detail B).

Detail B

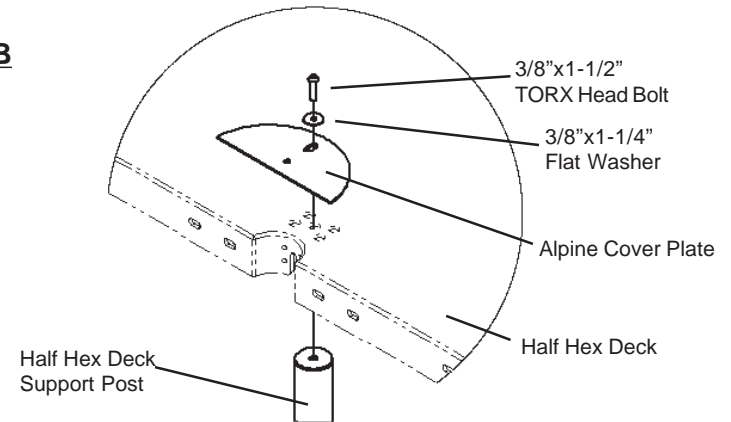

STEP 5

Verify that deck is level. Drill a 21/64" pilot hole into post through center of slot in deck. Select one 3/8"x1-1/2" self tapping screw and one 3/8"x1-1/4" flat washer. Insert screw through washer, top of slot in deck and into pilot hole in post. Tighten hardware. Select two 1/4"x1" self drilling/tapping screws. Insert screws into bottom holes in deck and tighten.

Detail C

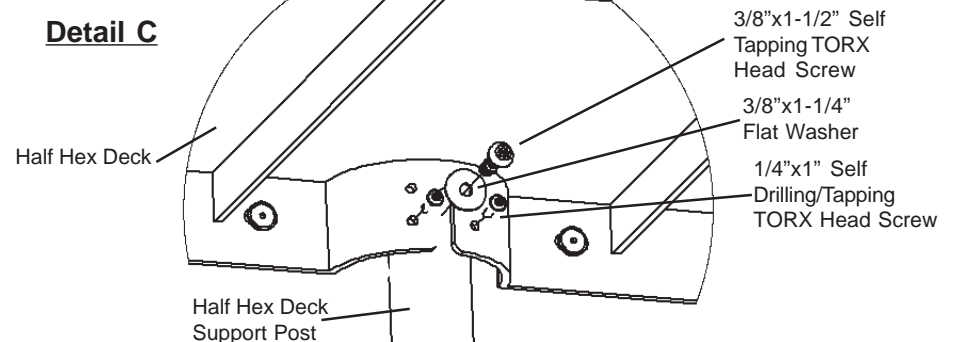

STEP 6

Select slide and eight 1/4" wafer bolts. Set slide in place in footings. Align holes in deck with holes in slide. **NOTE:** Two outermost holes in each side of deck will not be used. Attach slide to deck by inserting wafer bolt through deck and screw into inserts in slide (see Detail D). Repeat for remaining wafer bolts. Gently tighten until all are installed. Then tighten all. **NOTE:** Slide is designed for use with a 72" deck height. If a different deck height is being used, a distance of 72" must be maintained from deck to bottom of slide.

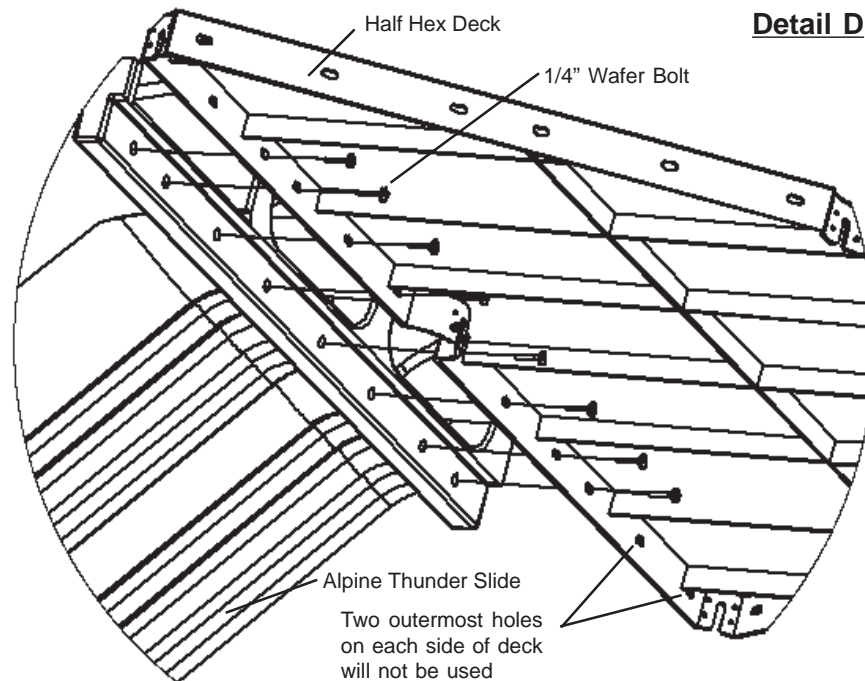

STEP 7

Select two C-Line panel fittings and two sealing gaskets for C-Line fittings. Remove backing from one side of gasket and press on to back of fitting (see Detail E). **NOTE:** Gasket is covered with a strong adhesive - do not press on to fitting until gasket is centered. Repeat for other gasket and fitting.

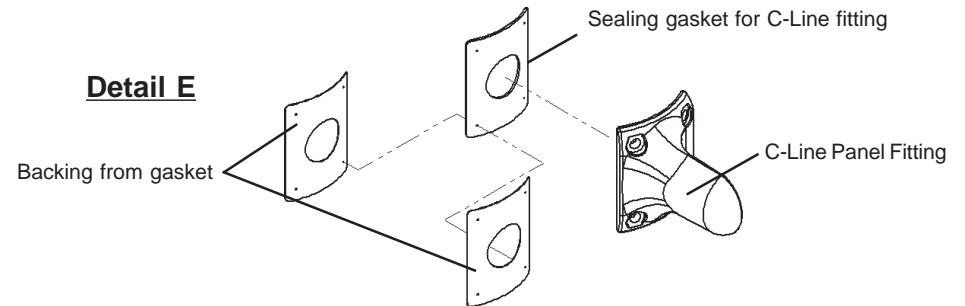

STEP 8

Select same two C-Line panel fittings, two 3/8"x1-1/4" security TORX head bolts, two 3/8"x1-1/4" flat washers and the alpine sit-down. Attach fittings to sit-down as shown in Detail F, making sure that both fittings are placed on the same side of the alpine sit-down. **NOTE:** Gently tighten hardware at this time to allow for adjustment later.

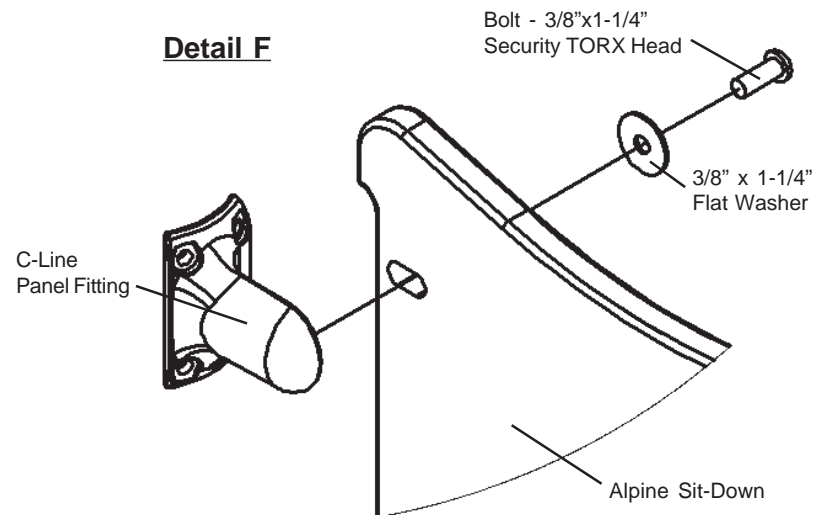

INSTALLATION GUIDELINES

STEP 9

Select alpine sit-down with fittings attached. Position sit-down so that rounded side of fittings are facing away from deck and sit-down is resting on top of deck.

STEP 10

Verify that sit-down is level. Drill a 1/2" hole through sit-down and into slide.

STEP 11

Select four zip togglers and four 1/4" wafer bolts. Insert zip togglers through sit-down into holes in slide, pull tight and snap off extra plastic. Insert wafer bolt into toggler and gently tighten until all four sets are installed. Then tighten all (see diagram and Detail G).



1. Insert in hole.

2. Zip flush with surface.

3. Snap off flush with surface.

4. Tighten bolt flush.

Detail G

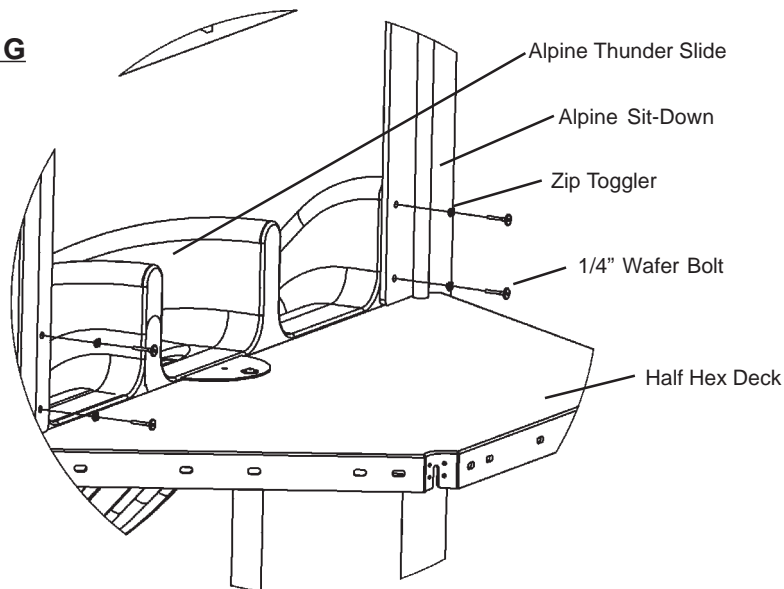

STEP 12

Remove backing from other side of gaskets. Slide fittings toward vertical posts and press into place.

STEP 13

Select sixteen 1/4"x1" self tapping TORX head screws. Secure each fitting to vertical post by installing four screws into each fitting. Lightly tighten until all four screws are installed. Then tighten all four self tapping screws. Repeat for other fittings (see Detail H).

NOTE: Must use high speed 3/8" electric drill w/clutch. Use of any other driver may result in damage to tool and/or hardware.

Detail H

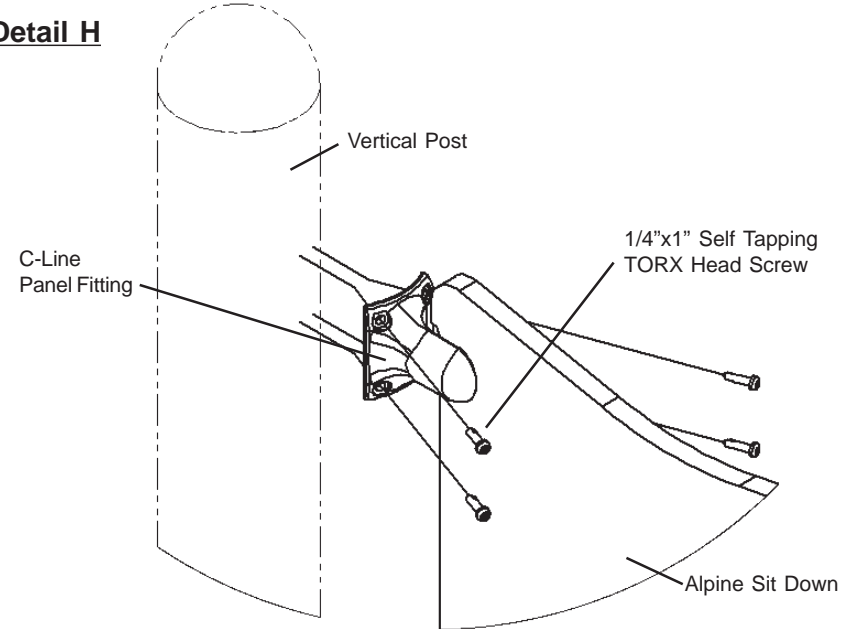

STEP 14

Pour concrete in footings to correct level. **NOTE:** Concrete must have a minimum rating of 2,500 psi and must be mixed per manufacturer's recommendations. **Allow concrete to dry for at least 48 hours before use!**

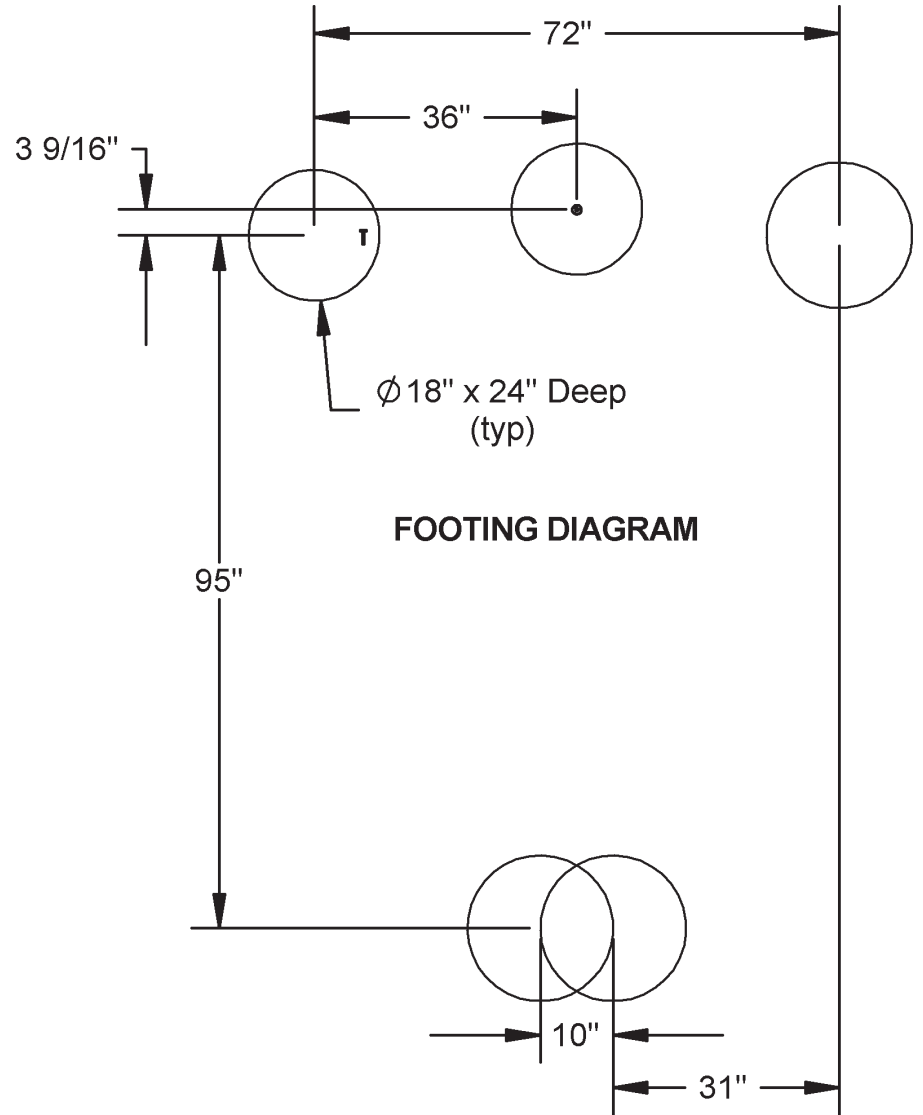
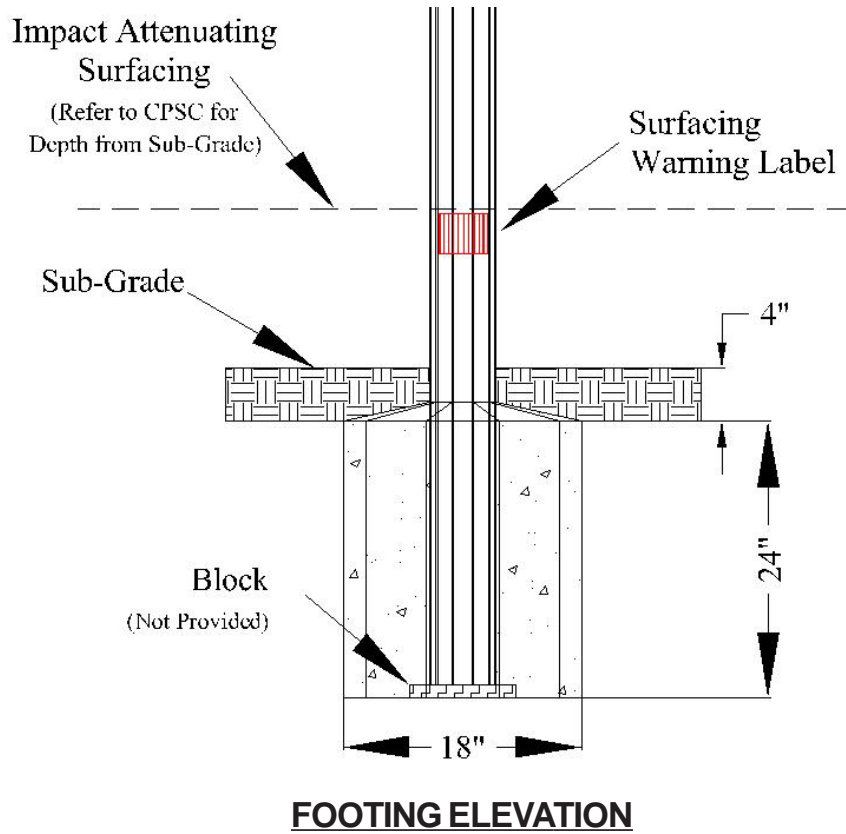

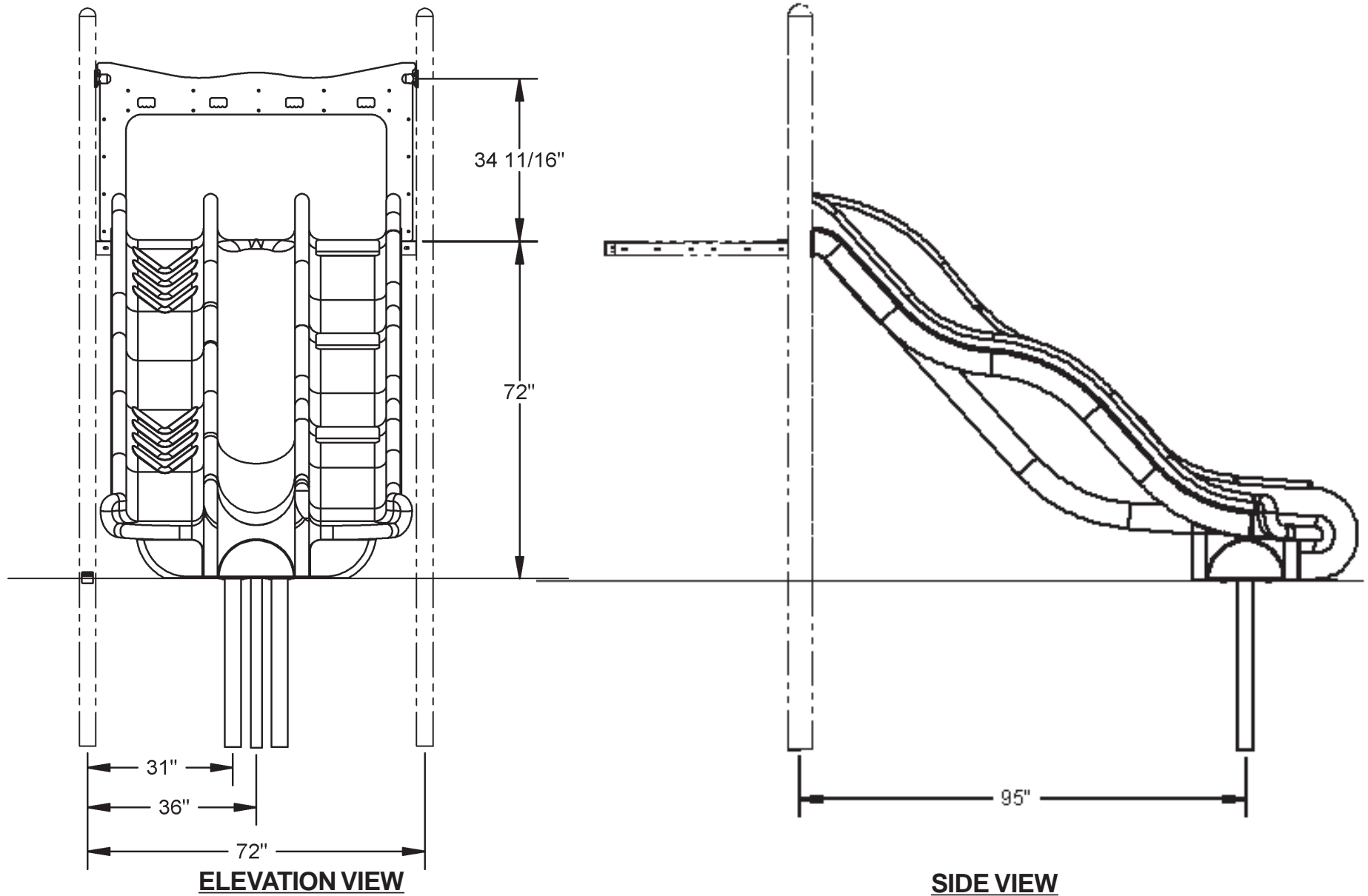

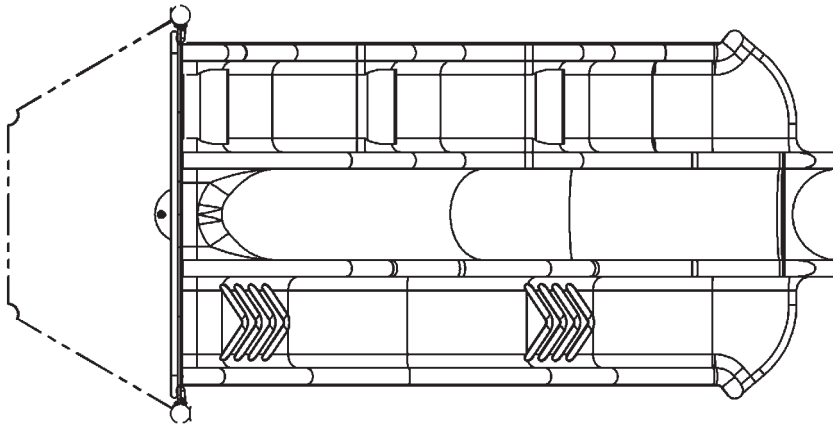

OVERHEAD VIEW

**BILL OF MATERIALS
PART / HARDWARE LIST**

ITEM NO.	QTY.	PART NO.	DESCRIPTION
1	1	00152XX	Alpine Thunder Slide - Roto-Molded Plastic
2	1	10308002XX	Alpine Cover Plate
3	1	AFB40429XX	Post - Half Hex Deck Support
4	1	2080011592	Bolt - 3/8" x 1-1/2" Security Torx With Patch
5	8	2080011192	Bolt - 3/8" x 1" Security Torx With Patch
6	1	RSA02002XX	Alpine Sit-Down Bar 3.5 C-Line
7	9	2090010292	Washer - 3/8"x1-1/4" Flat
8	2	30008501XX	Fab Wdmt. - Standard Slide Foot
9	12	2080060192	Bolt - 1/4" x 1 3/4" Wafer
10	4	2100030192	Nut - 1/4"-20 Zip Toggler
11	2	CTG10006XX	Fitting - Panel Mount 5"
12	2	HDW32550XX	3-1/2" Sealing Gasket
13	8	2080000192	Screw - 1/4" x 1" Self Tapping Torx w/Patch
14	2	20800112XX	BH Bolt - 1/4" x 1/2"

PRODUCT SPECIFICATIONS

HARDWARE

- Conforms to ANSI/ASCE-8-90
- Tamper resistant
- Special tool required for install

FITTINGS

- Aluminum alloy (GM70B) manufactured and tested in accordance with the following ASTM Standards: B179-68, B108-68, E10-66, E8-66
- Powder coat finish
- Predrilled

SEALING GASKET

- Neoprene rubber
- 60 +/- 5 durometer hardness
- Double sided adhesive

SUPPORT POST

- 1-3/8" O.D. round
- 13 gauge galvanized steel support post
- 50,000 psi yield strength (ASTM E-8)
- 55,000 psi tensile strength (ASTM E-8)
- 12 gauge galvanized steel plate
- Triple Flo-Coated corrosion protection (interior/exterior)
- Interior and exterior corrosion resistance (ASTM B-117)
- Manufactured per ASTM 500
- Powder coat finish

PRODUCT SPECIFICATIONS

ALPINE SIT-DOWN

- 3/4" high density Polyethylene sheeting
- Tested in accordance with ASTM D1928 Procedure C
- Textured finish
- 4,400 psi tensile strength (ASTM D638)
- UV stabilized

ALPINE THUNDER SLIDE

- 1st quality linear low density Polyethylene (ExxonMobil LL8450)
- Rotational molded
- 2,550 psi tensile strength (ASTM D638)
- UV stabilized
- 3/8" Wall thickness
- Anti-static inhibitors

SLIDE FOOT

- 3.5" O.D. support post
- 13 gauge galvanized steel support post
- 50,000 psi yield strength (ASTM E-8)
- 55,000 psi tensile strength (ASTM E-8)
- 12 gauge galvanized steel plate
- Triple Flo-Coated corrosion protection (interior/exterior)
- Interior and exterior corrosion resistance (ASTM B-117)
- Manufactured per ASTM 500
- Powder coat finish

PRETREATMENT WASH PRIMER

- 4860-420 primer / 1000-44 activator
- Polyvinyl-butylal resin based primer
- Used on all milled steel and all weld joints
- Designed to give adhesion to a wide variety of metal substrates
- Provides added metal protection against rust
- Imparts extra durability to topcoat (powder coat)
- When reduced properly, it meets the definition of a "pretreatment" primer found in many air quality regulations

POWDER COAT FINISH

- TGIC Polyester
- Electrostatic application
- Baked-on @ 400 degrees
- 5-7 mills thick
- Lead free
- High gloss
- No peel / No flake finish
- Resistant to salt spray (ASTM B117)
- Resistant to humidity (ASTM D2247)
- Direct/Indirect impact 120 in. pounds (ASTM D2794)
- Good to excellent resistance to most solvents, oils, acids and alkalies