

**TRADITIONAL TEETER-TOTTER  
#90017009XX**

**USER GROUP:** 5-12 years

**RECOMMENDED CREW:** 2 people

**TOOLS REQUIRED:**

Shovel / Post Hole Digger / Auger

T-45 Tool (supplied by manufacturer)

High Speed 3/8" Electric Drill w/clutch

**NOTE:** Use of any other driver may result in damage to tool and/or hardware!

**INSTALLATION TIME:** Approximately 1 hour

**WEIGHT:** 73 lbs.

**CONCRETE REQUIRED:** 2.36 cubic feet

**NOTE:** Concrete must have a minimum rating of 2,500 psi and must be mixed per manufacturer's recommendations.

**PRE-INSTALLATION CHECK:**

Compare all items received to the packing list. Notify your local sales representative immediately if any parts are missing or damaged.

**We are not responsible for items discovered missing after 72 hours from time of delivery!**

Before beginning installation, make sure that you have read and understand the **Installation Introduction** manual that was supplied to you. If you did not receive a copy, or if you have a question regarding anything covered in this manual, contact your local sales representative.

**TRADITIONAL TEETER-TOTTER  
#90017009XX**

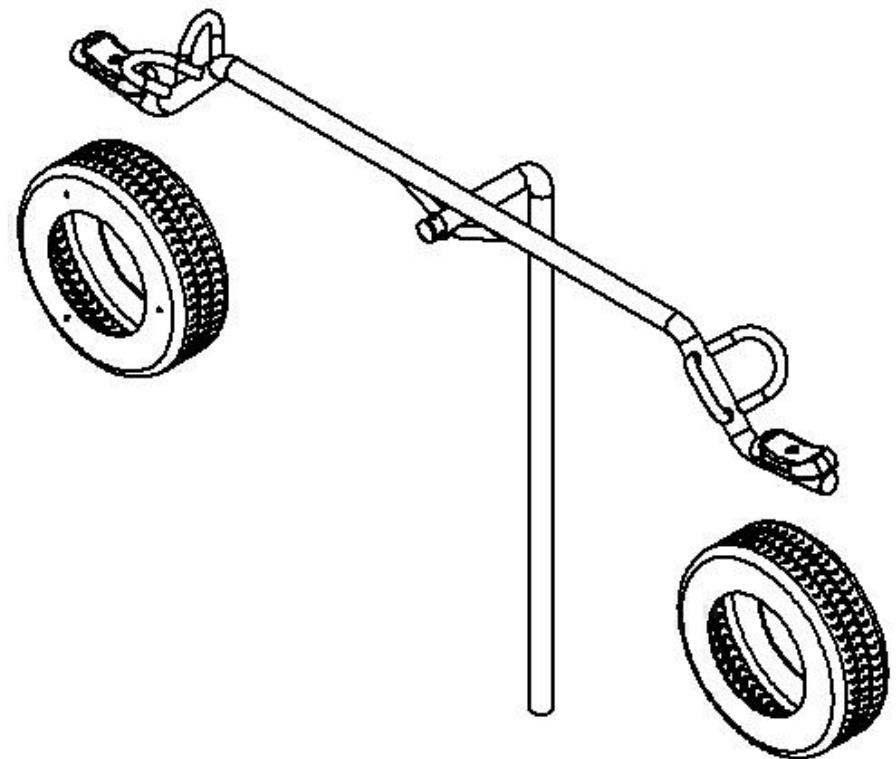

## INSTALLATION GUIDELINES

### STEP 1

Refer to PLAN VIEW and FOOTING LAYOUT to locate position of traditional teeter totter. Excavate footing hole and holes for tires as shown in FOOTING ELEVATION and FOOTING LAYOUT. Place a 2" spacer in bottom of footing hole.

### STEP 2

Place tires in holes at a depth to allow 3" of the tire to be exposed above the finished surfacing. Place teeter totter leg into footing hole and brace into position. Top of teeter totter will be 24" above finished surfacing.

### STEP 3

Select teeter totter leg, body, collar, one 3/8"x2-1/2" TORX head bolt and one 3/8"x1" round weld nut. Slide collar into welded "V" in center of body. Slide body/collar onto leg with "V" facing down. Insert bolt through collar and leg and secure with weld nut.

### Detail A

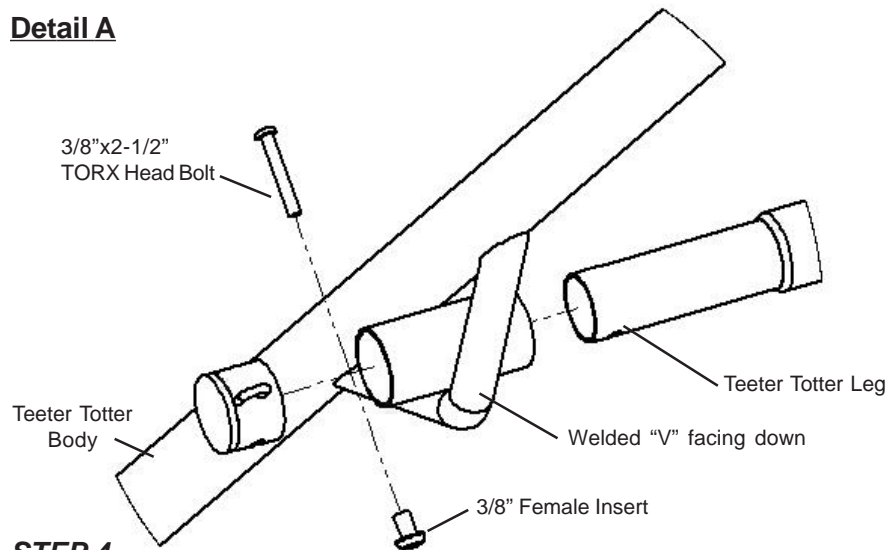

### STEP 4

Select seat, one 3/8"x3-3/4" TORX head bolt, one 3/8"x1-1/4" flat washer and one 3/8" round weld nut. Attach seat to teeter totter body by inserting bolt down through washer, seat, body and into weld nut as shown in Detail B. Repeat for other side.

### Detail B

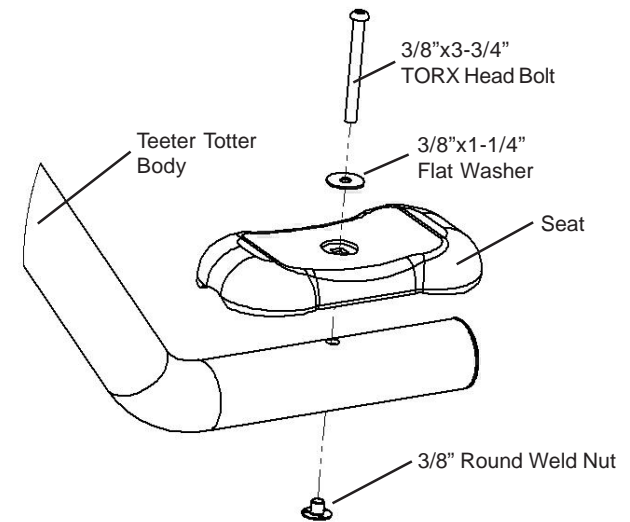

### STEP 5

Verify that all hardware is secure. Pour concrete in footing to correct level. **NOTE:** Concrete must have a minimum rating of 2,500 psi and must be mixed per manufacturer's recommendations. **Allow concrete to dry for at least 48 hours before use!**

### BILL OF MATERIALS PART/HARDWARE LIST

| ITEM NO. | QTY. | PART NO.                           | DESCRIPTION                 |
|----------|------|------------------------------------|-----------------------------|
| 1        | 1    | AFB47697XX WLDMT.                  | - Traditional Teeter-Totter |
| 2        | 1    | FAB37695XX                         | Teeter-Totter Leg           |
| 3        | 1    | AFB47705XX Wldmt.                  | - Teeter-Totter Collar      |
| 4        | 1    | 2080012592 Bolt - 3/8" x 2-1/2"    | Security Torx With Patch    |
| 5        | 1    | PL03                               | Nut - 3/8"-16 Female Insert |
| 6        | 2    | TTSEATXX                           | Teeter-Totter Seat          |
| 7        | 2    | 2080037592 Bolt - 3/8" x 3 3/4"    | Security Torx With Patch    |
| 8        | 2    | 2090010292 Washer - 3/8x1-1/4 Flat |                             |
| 9        | 2    | 2100010392 Nut - 3/8" x 1"         | Round Weld Nut              |
| 10       | 2    | 90015500XX                         | Tire (used for Tire Swing)  |

12" DIAMETER X 36" DEEP

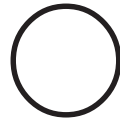

**FOOTING DETAIL**

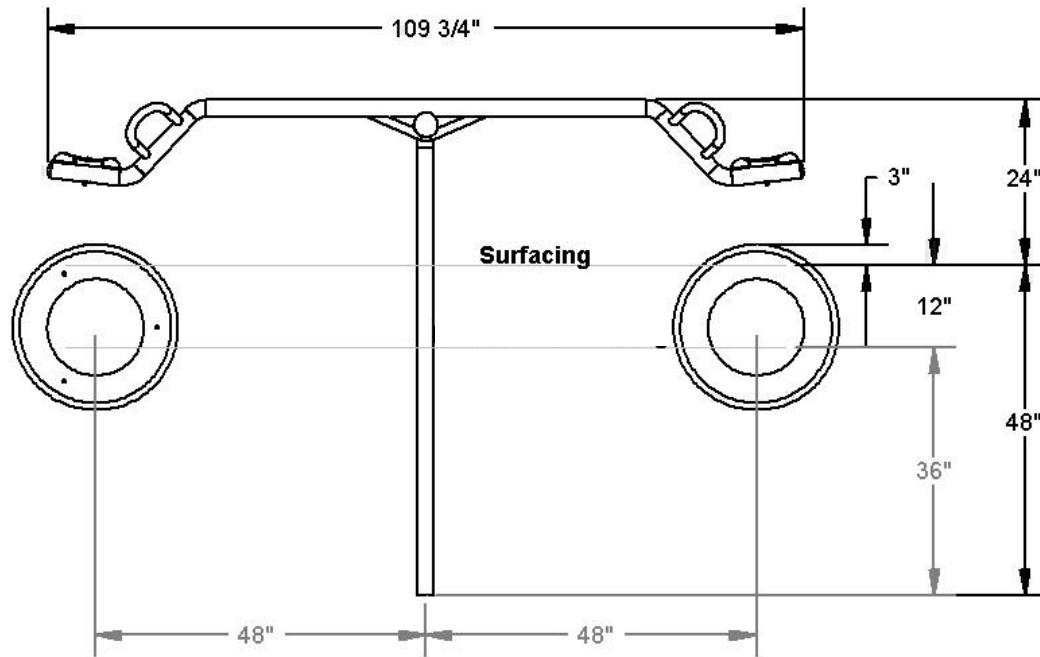

**SIDE ELEVATION**

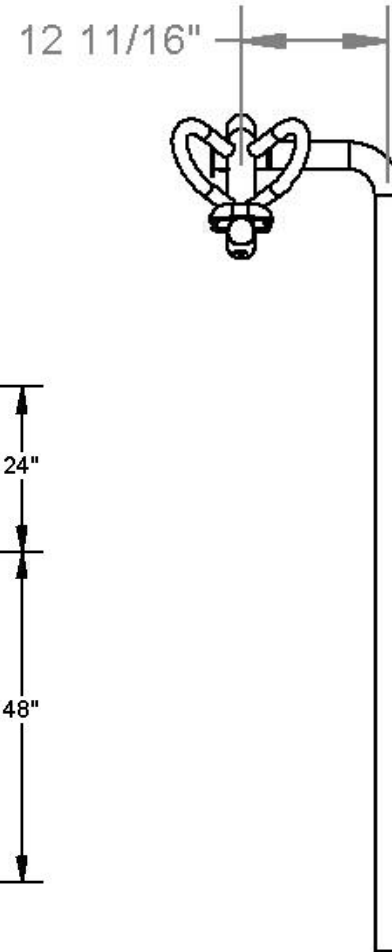

**SIDE DETAIL**

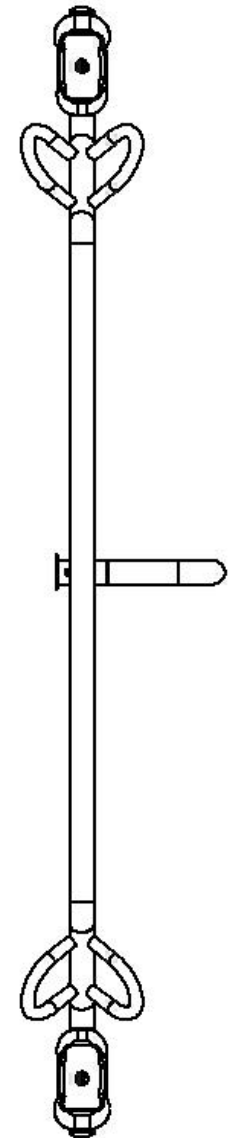

**OVERHEAD DETAIL**

## PRODUCT SPECIFICATIONS

### **TEETER TOTTER LEG AND BODY**

- 2-3/8" O.D. round steel tube
- 9 gauge steel
- 50,000 psi yield strength (ASTM E-8)
- 55,000 psi tensile strength (ASTM E-8)
- Triple zinc coated undercoat
- Powder coat finish

### **TEETER TOTTER COLLAR SHEET**

- 3-1/2" O.D. round galvanized steel
- A36 or Class 1 steel
- Triple zinc coated undercoat
- Powder coat finish

### **STUB**

- 2-3/8" O.D. round steel tube
- 9 gauge steel
- 50,000 psi yield strength (ASTM E-8)
- 55,000 psi tensile strength (ASTM E-8)
- Triple zinc coated undercoat
- Powder coat finish

### **HARDWARE**

- Tamper resistant
- Special tool required for install

### **TEETER TOTTER BRACE AND HAND HOLDS**

- 1-1/4" O.D. round steel tube
- 14 gauge steel
- 50,000 psi yield strength (ASTM E-8)
- 55,000 psi tensile strength (ASTM E-8)
- Triple zinc coated undercoat
- Powder coat finish

### **TEETER TOTTER SEAT**

- Cast aluminum alloy (GM70B) manufactured and tested in accordance with the following ASTM Standards: B179-68, B108-68, E10-66, E8-66
- Powder coat finish
- Predrilled

## PRODUCT SPECIFICATIONS

### **PRETREATMENT WASH PRIMER**

- 4860-420 primer / 1000-44 activator
- Polyvinyl-butyril resin based primer
- Used on all milled steel and all weld joints
- Designed to give adhesion to a wide variety of metal substrates
- Provides added metal protection against rust
- Imparts extra durability to topcoat (powder coat)
- When reduced properly, it meets the definition of a “pretreatment” primer found in many air quality regulations

### **POWDER COAT FINISH**

- TGIC Polyester
- Electrostatic application
- Baked-on @ 400 degrees
- 5-7 mills thick
- Lead free
- High gloss
- No peel / No flake finish
- Resistant to salt spray (ASTM B117)
- Resistant to humidity (ASTM D2247)
- Direct/Indirect impact 120 in. pounds (ASTM D2794)
- Good to excellent resistance to most solvents, oils, acids and alkalies