

**JUNIOR ACCESSIBLE SAND DIGGER
#90017111XX**

USER GROUP: 2-12 years

RECOMMENDED CREW: 2 people

TOOLS REQUIRED:

- Shovel / Post Hole Digger / Auger
- T-30 Tool (supplied by manufacturer)
- T-45 Tool (supplied by manufacturer)
- Level
- High Speed 3/8" Electric Drill *w/clutch*

NOTE: Use of any other driver may result in damage to tool and/or hardware!

INSTALLATION TIME: Approximately 1 hour

WEIGHT: 49 lbs.

CONCRETE REQUIRED: 1.57 cubic feet

NOTE: Concrete must have a minimum rating of 2,500 psi and must be mixed per manufacturer's recommendations.

PRE-INSTALLATION CHECK:

Compare all items received to the packing list. Notify your local sales representative immediately if any parts are missing or damaged.

We are not responsible for items discovered missing after 72 hours from time of delivery!

Before beginning installation, make sure that you have read and understand the **Installation Introduction** manual that was supplied to you. If you did not receive a copy, or if you have a question regarding anything covered in this manual, contact your local sales representative.

**JUNIOR ACCESSIBLE SAND DIGGER
#90017111XX**

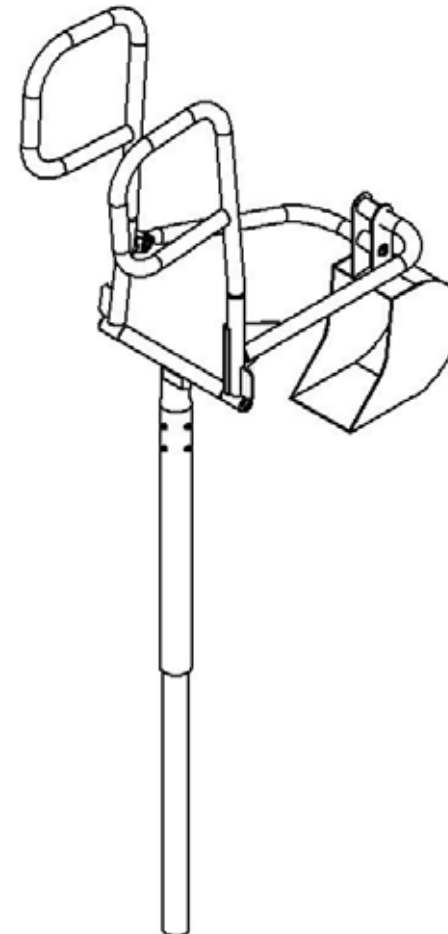

STEP 1

Refer to PLAN VIEW and FOOTING LAYOUT to locate position of junior accessible sand digger. Excavate footing hole as shown in FOOTING ELEVATION and FOOTING LAYOUT. Place a 2" spacer in bottom of hole.

STEP 2

Select right handle, anchor, one 3/8"x3" TORX head bolt, one 3/8"x7/8" OD flat washer and one 3/4"x2" bushing. Attach right handle to seat assembly by inserting bolt through washer, bushing, handle and into seat assembly as shown in Detail A. Tighten hardware.

Detail A

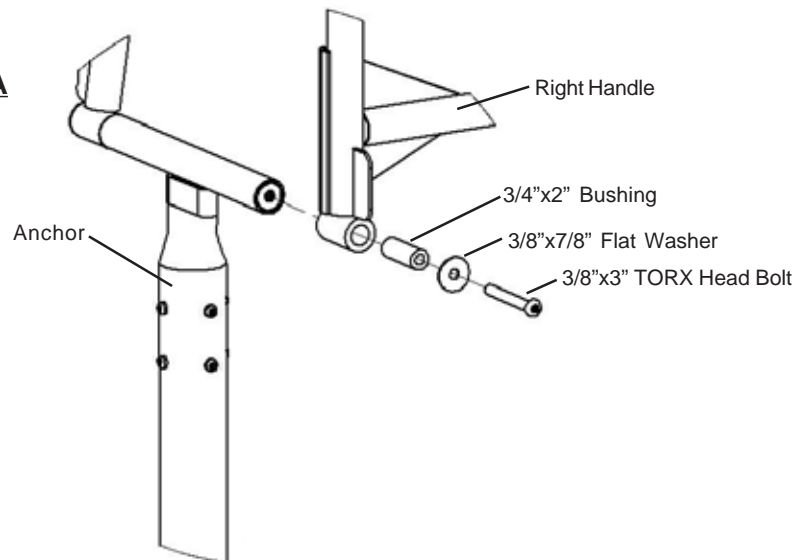

STEP 3

Select left handle, one 3/8"x3" TORX head bolt, one 3/8"x7/8" OD flat washer and one 3/4"x2" bushing. Attach left handle to anchor by inserting bolt through washer, bushing, handle and into anchor. Tighten hardware.

STEP 4

Select left arm assembly, two 3/8"x3/4" TORX head bolts, two flanged arm bushings and two 3/8"x7/8" OD washers and one 3/8" coupling nut. Slide left arm assembly into bracket on left handle. Insert coupling nut. From each side, insert bolt through washer, arm bushing, bracket and into coupling nut as shown in Detail C. Tighten hardware.

Detail B

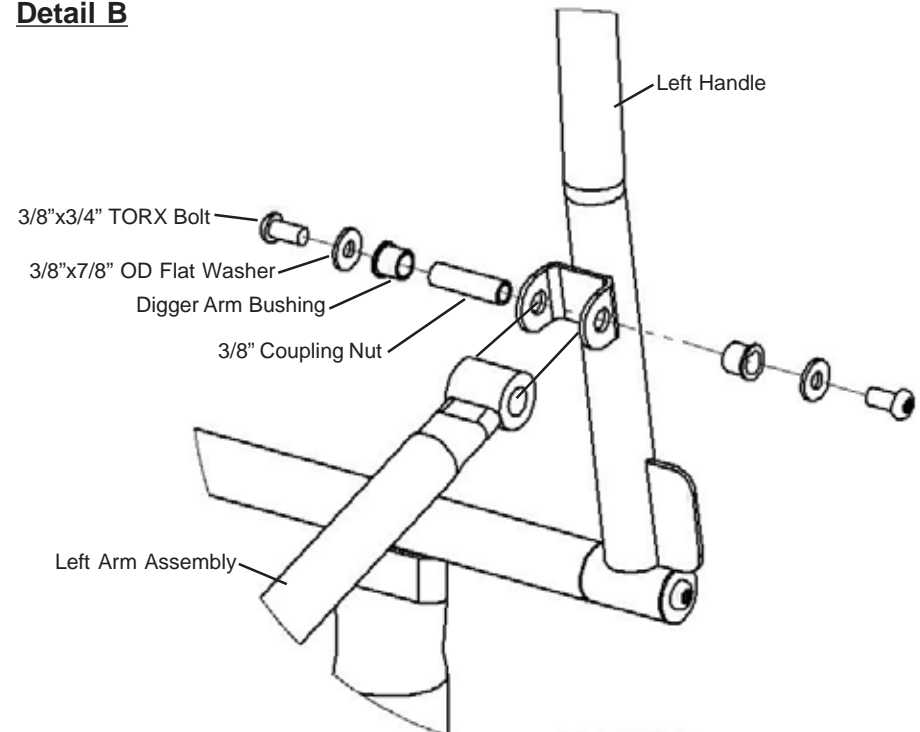

STEP 5

Select scoop, two handle/arm pivots, two 3/8"x7/8" OD flat washers and two 3/8"x3" TORX bolts. Slide pivots between each set of holes of scoop. From each side, insert bolt through washer, scoop, pivot, other side of scoop and tighten into handle/arm assembly as shown in Detail C. Tighten hardware.

Detail C

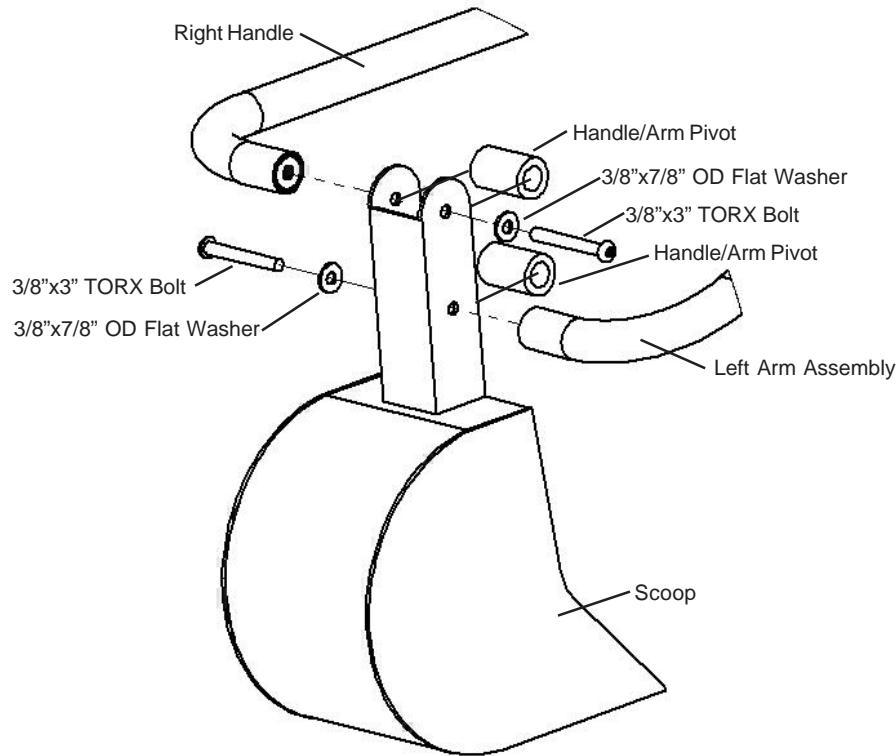

STEP 6

Select sand digger assembly, in-ground post and eight 1/4"x1" self tapping TORX screws. Place post in footing hole. Slide sand digger assembly over post and secure with two screws in each side as shown in Detail D.

Detail D

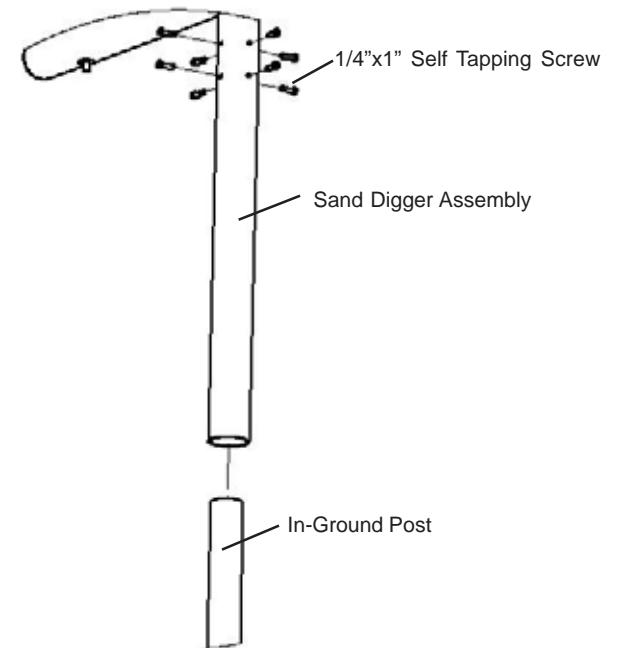

STEP 7

Block and brace sand digger to correct height. Top of sand digger bucket will be 19-1/4" above finished surfacing. Pour concrete in footing to correct level. **NOTE:** Concrete must have a minimum rating of 2,500 psi and must be mixed per manufacturer's recommendations. **Allow concrete to dry for at least 48 hours before use!**

**BILL OF MATERIALS
PART/HARDWARE LIST**

ITEM NO.	QTY.	PART NO.	DESCRIPTION
1	1	AFB47914XX	Wldmt. - Digger Anchore
2	1	AFB47889XX	Accessible Digger Handle - R.H.
3	1	AFB47890XX	Accessible Digger Handle - L.H.
4	1	AFB47895XX	Wldmt. - Left Arm Assembly - Digger
5	1	diggerscoop	Scoop for Sand Digger
6	2	FAB17886XX	Handle Arm Pivot/Digger
7	4	2090010492	Washer - 3/8"x7/8" OD Flat
8	4	2080010392	Bolt - 3/8"x3" Security Torx With Patch
9	1	HDW47907XX	3/8" Coupling Nut
10	2	812052T	Bolt - 3/8"x3/4" Torx With Patch
11	2	HDW37909XX	Digger Arm Bushing - Flanged
12	2	MSC07913XX	Bushing - 3/4" OD x 2"
13	2	2090010292	Washer - 3/8"x1-1/4" Flat
14	1	FAB37898XX	In Ground Post - Accessible Digger
15	8	2080000192	Screw - 1/4"x1" Self Tapping Torx w/Patch

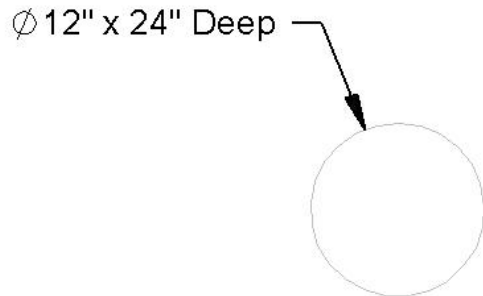

FOOTING DETAIL

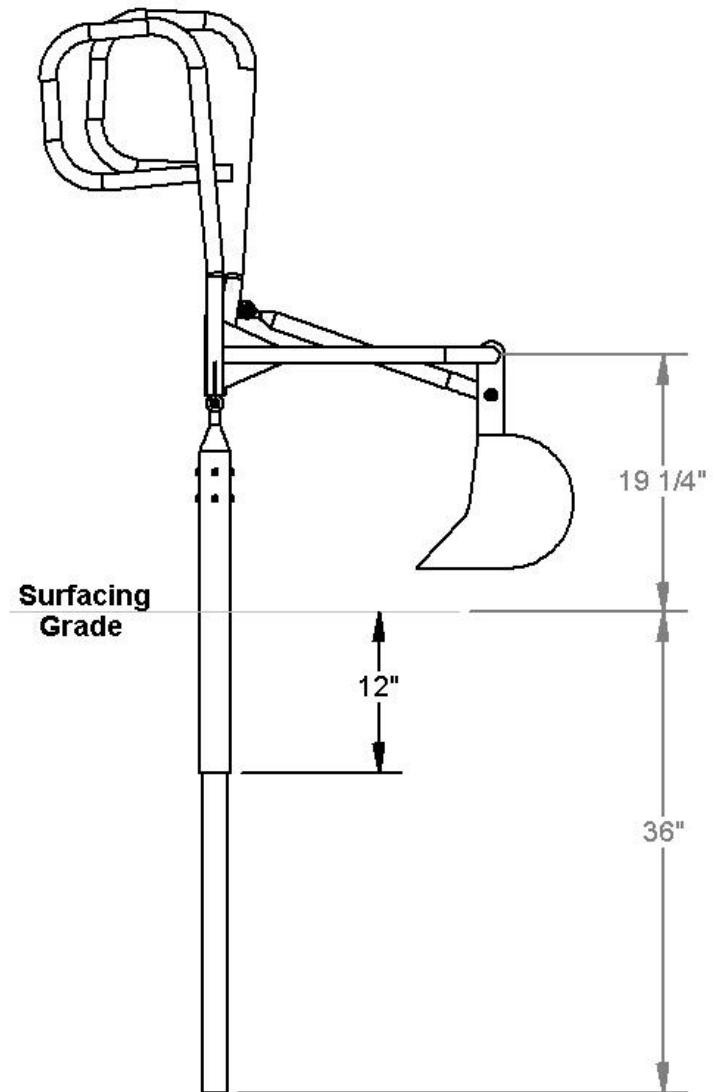

SIDE ELEVATION

PRODUCT SPECIFICATIONS**JUNIOR DIGGER HANDLES AND ARM EXTENSION**

- 11-1/4" O.D. round steel tube
- 14 gauge steel
- 50,000 psi yield strength (ASTM E-8)
- 55,000 psi tensile strength (ASTM E-8)
- Triple zinc coated undercoat
- Powder coat finish

JUNIOR DIGGER IN-GROUND POST

- 1-7/8" O.D. round steel tube
- 11 gauge steel
- 50,000 psi yield strength (ASTM E-8)
- 55,000 psi tensile strength (ASTM E-8)
- Triple zinc coated undercoat
- Powder coat finish

JUNIOR DIGGER FRAME

- 2-3/8" O.D. round steel tube
- 9 gauge steel
- 50,000 psi yield strength (ASTM E-8)
- 55,000 psi tensile strength (ASTM E-8)
- Triple zinc coated undercoat
- Powder coat finish

HARDWARE

- Tamper resistant
- Special tool required for install

PRETREATMENT WASH PRIMER

- 4860-420 primer / 1000-44 activator
- Polyvinyl-butyril resin based primer
- Used on all milled steel and all weld joints
- Designed to give adhesion to a wide variety of metal substrates
- Provides added metal protection against rust
- Imparts extra durability to topcoat (powder coat)
- When reduced properly, it meets the definition of a "pretreatment" primer found in many air quality regulations

POWDER COAT FINISH

- TGIC Polyester
- Electrostatic application
- Baked-on @ 400 degrees
- 5-7 mills thick
- Lead free
- High gloss
- No peel / No flake finish
- Resistant to salt spray (ASTM B117)
- Resistant to humidity (ASTM D2247)
- Direct/Indirect impact 120 in. pounds (ASTM D2794)
- Good to excellent resistance to most solvents, oils, acids and alkalis