

**JUNIOR SAND DIGGER
#90017110XX**

USER GROUP: 2-12 years

RECOMMENDED CREW: 2 people

TOOLS REQUIRED:

- Shovel / Post Hole Digger / Auger
- T-30 Tool (supplied by manufacturer)
- T-45 Tool (supplied by manufacturer)
- Level
- High Speed 3/8" Electric Drill *w/clutch*

NOTE: Use of any other driver may result in damage to tool and/or hardware!

INSTALLATION TIME: Approximately 1 hour

WEIGHT: 49 lbs.

CONCRETE REQUIRED: 1.57 cubic feet

NOTE: Concrete must have a minimum rating of 2,500 psi and must be mixed per manufacturer's recommendations.

**JUNIOR SAND DIGGER
#90017110XX**

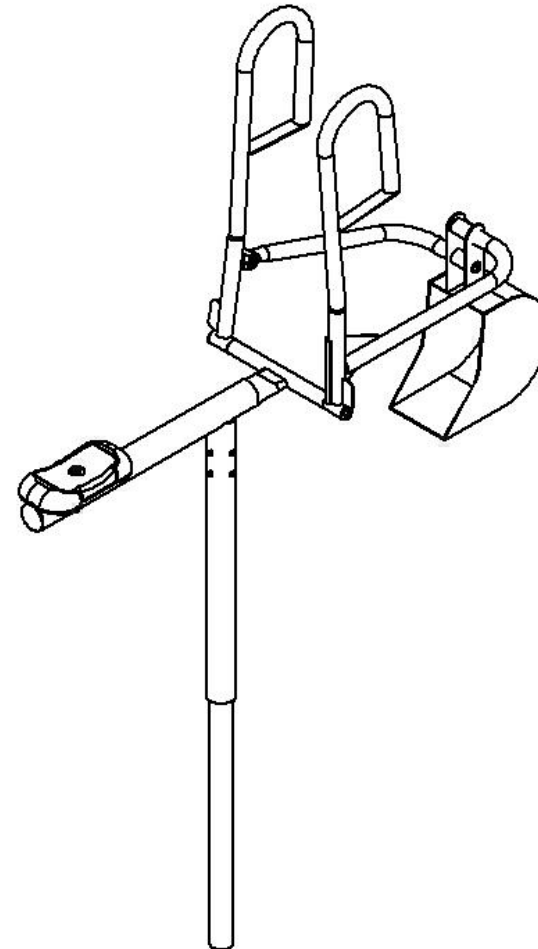

PRE-INSTALLATION CHECK:

Compare all items received to the packing list. Notify your local sales representative immediately if any parts are missing or damaged.

We are not responsible for items discovered missing after 72 hours from time of delivery!

Before beginning installation, make sure that you have read and understand the **Installation Introduction** manual that was supplied to you. If you did not receive a copy, or if you have a question regarding anything covered in this manual, contact your local sales representative.

STEP 1

Refer to PLAN VIEW and FOOTING LAYOUT to locate position of junior sand digger. Excavate footing hole as shown in FOOTING ELEVATION and FOOTING LAYOUT. Place a 2" spacer in bottom of hole.

STEP 2

Select seat, one 3/8"x3-3/4" TORX head bolt, one 3/8"x1-1/4" flat washer and one 3/8" round weld nut. Position seat on sand digger body with widest end of seat toward back of sand digger. Attach seat to sand digger body by inserting bolt down through washer, seat, body and into weld nut as shown in Detail A.

Detail A

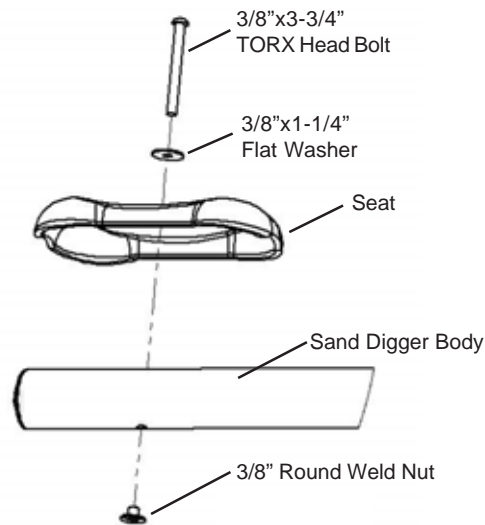

STEP 3

Select right handle, seat assembly, one 3/8"x3" TORX head bolt, one 3/8"x7/8" OD flat washer and one 3/4"x2" bushing. Attach right handle to seat assembly by inserting bolt through washer, bushing, handle and into seat assembly as shown in Detail B. Tighten hardware.

Detail B

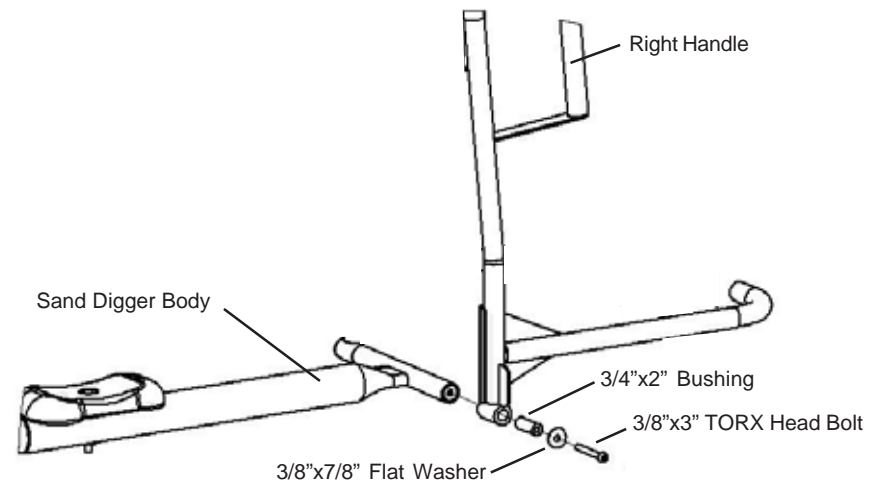

STEP 4

Select left handle, one 3/8"x3" TORX head bolt, one 3/8"x7/8" OD flat washer and one 3/4"x2" bushing. Attach left handle to seat assembly by inserting bolt through washer, bushing, handle and into seat assembly. Tighten hardware.

STEP 5

Select left arm assembly, two 3/8"x3/4" TORX head bolts, two flanged arm bushings and two 3/8"x7/8" OD washers and one 3/8" coupling nut. Slide left arm assembly into bracket on left handle. Insert coupling nut. From each side, insert bolt through washer, arm bushing, bracket and into coupling nut as shown in Detail C. Tighten hardware.

Detail C

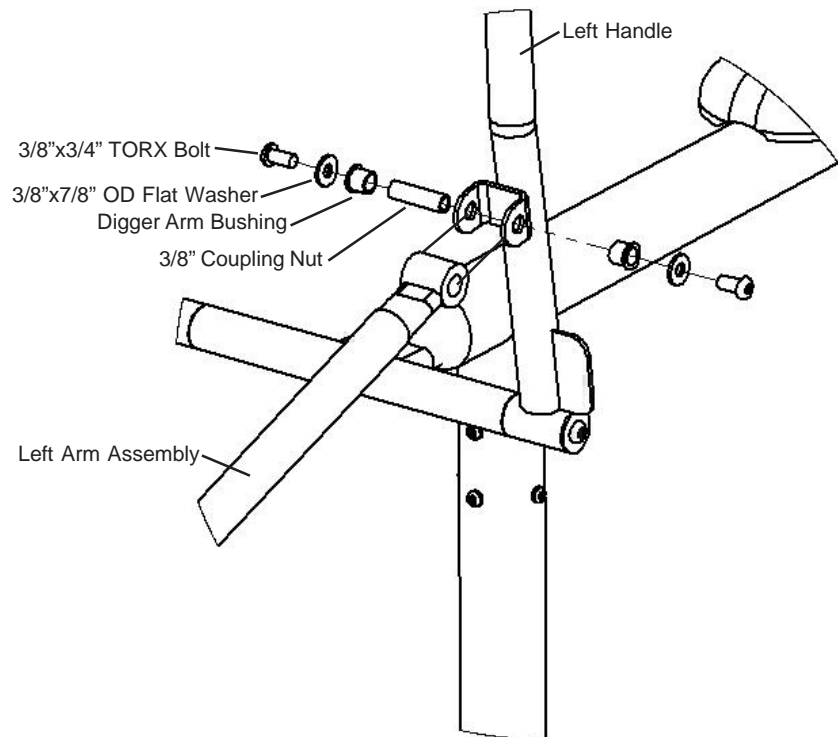

STEP 6

Select scoop, two handle/arm pivots, two 3/8"x7/8" OD flat washers and two 3/8"x3" TORX bolts. Slide pivots between each set of holes of scoop. From each side, insert bolt through washer, scoop, pivot, other side of scoop and tighten into handle/arm assembly as shown in Detail D. Tighten hardware.

Detail D

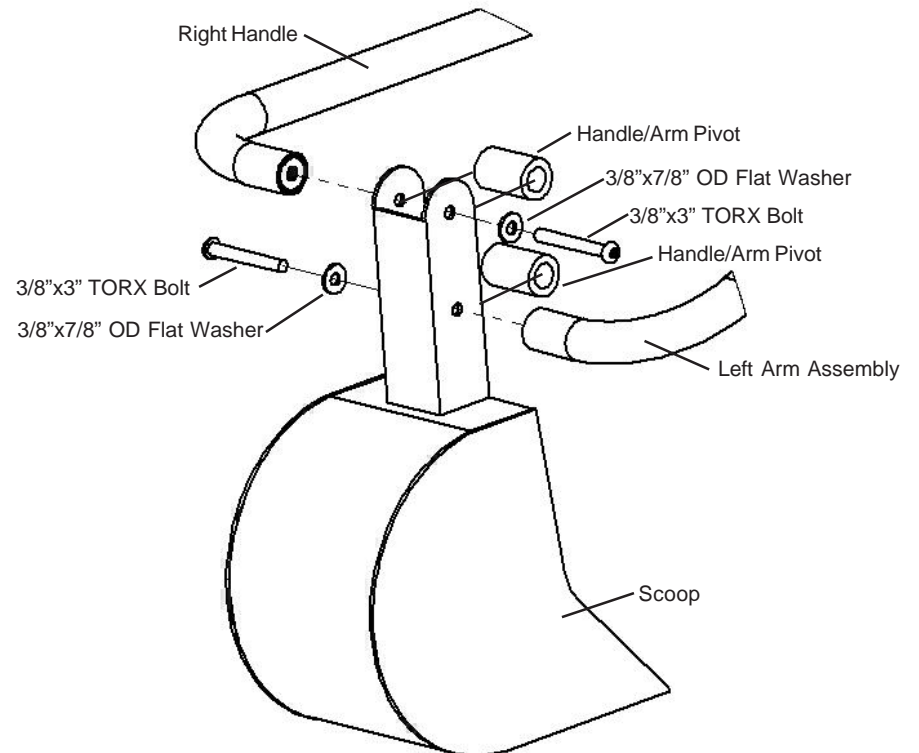

STEP 7

Select sand digger assembly, in-ground post and eight 1/4"x1" self tapping TORX screws. Place post in footing hole. Slide sand digger assembly over post and secure with two screws in each side.

**BILL OF MATERIALS
PART/HARDWARE LIST**

Detail E

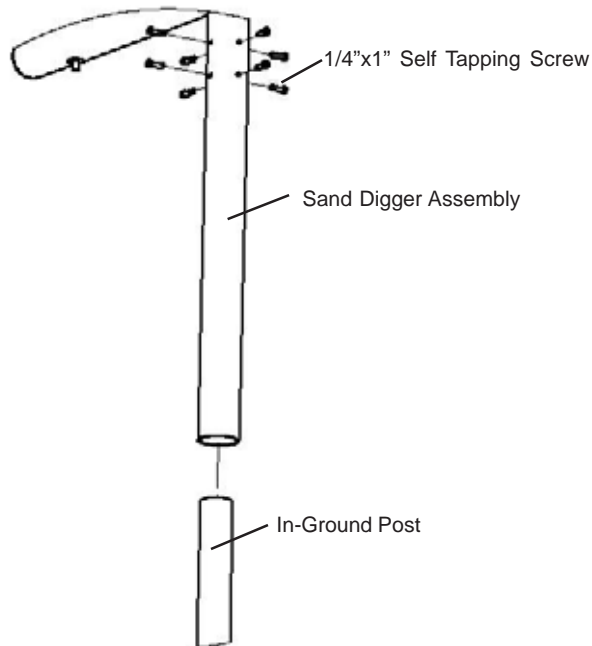

ITEM NO.	QTY.	PART NO.	DESCRIPTION
1	1	AFB47937XX	Wldmt. - Junior Digger Seat Asm.
2	1	AFB47932XX	Wldmt. - Junior Digger Handle R.H.
3	1	AFB47933XX	Wldmt. - Junior Digger Handle L.H.
4	1	AFB47895XX	Wldmt. - Left Arm Assembly - Digger
5	1	diggerscoop	Scoop for Sand Digger
6	2	FAB17886XX	Handle Arm Pivot/Digger
7	4	2090010492	Washer - 3/8"x7/8" OD Flat
8	4	2080010392	Bolt - 3/8"x3" Security Torx w/Patch
9	1	HDW47907XX	3/8" Coupling Nut
10	2	812052T	Bolt - 3/8"x3/4" Torx w/Patch
11	2	HDW37909XX	Digger Arm Bushing - Flanged
12	2	MSC07913XX	Bushing - 3/4" OD x 2"
13	3	2090010292	Washer - 3/8"x1-1/4" Flat
14	1	FAB37898XX	In Ground Post - Accessible Digger
15	8	2080000192	Screw - 1/4"x1" Self Tapping Torx w/Patch
16	1	TTSEATXX	Teeter-Totter Seat
17	1	2080037592	Bolt - 3/8"x3-3/4" Security Torx w/Patch
18	1	2100010392	Nut - 3/8"x1" Round Weld Nut

STEP 8

Block and brace sand digger to correct height. Bottom of sand digger body should be 14-7/16" above finished surfacing. Pour concrete in footing to correct level. **NOTE:** Concrete must have a minimum rating of 2,500 psi and must be mixed per manufacturer's recommendations. **Allow concrete to dry for at least 48 hours before use!**

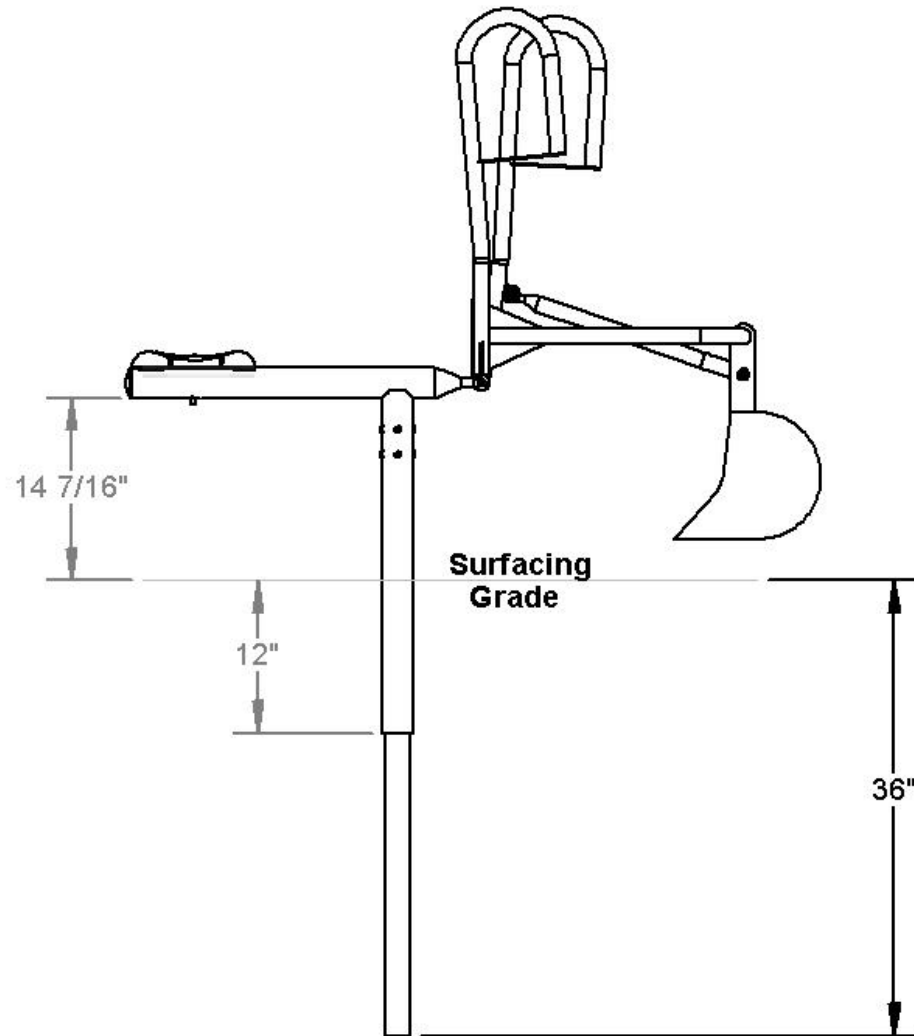

SIDE ELEVATION

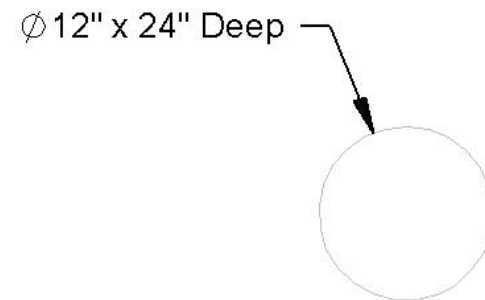

FOOTING DETAIL

PRODUCT SPECIFICATIONS**JUNIOR DIGGER HANDLES AND ARM EXTENSION**

- 11-1/4" O.D. round steel tube
- 14 gauge steel
- 50,000 psi yield strength (ASTM E-8)
- 55,000 psi tensile strength (ASTM E-8)
- Triple zinc coated undercoat
- Powder coat finish

JUNIOR DIGGER SEAT

- Cast aluminum alloy (GM70B) manufactured and tested in accordance with the following ASTM Standards: B179-68, B108-68, E10-66, E8-66
- Powder coat finish
- Predrilled

JUNIOR DIGGER IN-GROUND POST

- 1-7/8" O.D. round steel tube
- 11 gauge steel
- 50,000 psi yield strength (ASTM E-8)
- 55,000 psi tensile strength (ASTM E-8)
- Triple zinc coated undercoat
- Powder coat finish

JUNIOR DIGGER FRAME

- 2-3/8" O.D. round steel tube
- 9 gauge steel
- 50,000 psi yield strength (ASTM E-8)
- 55,000 psi tensile strength (ASTM E-8)
- Triple zinc coated undercoat
- Powder coat finish

HARDWARE

- Tamper resistant
- Special tool required for install

PRETREATMENT WASH PRIMER

- 4860-420 primer / 1000-44 activator
- Polyvinyl-butyril resin based primer
- Used on all milled steel and all weld joints
- Designed to give adhesion to a wide variety of metal substrates
- Provides added metal protection against rust
- Imparts extra durability to topcoat (powder coat)
- When reduced properly, it meets the definition of a "pretreatment" primer found in many air quality regulations

POWDER COAT FINISH

- TGIC Polyester
- Electrostatic application
- Baked-on @ 400 degrees
- 5-7 mills thick
- Lead free
- High gloss
- No peel / No flake finish
- Resistant to salt spray (ASTM B117)
- Resistant to humidity (ASTM D2247)
- Direct/Indirect impact 120 in. pounds (ASTM D2794)
- Good to excellent resistance to most solvents, oils, acids and alkalis